

## 阅读申明

- 1.本站收集的数据手册和产品资料都来自互联网，版权归原作者所有。如读者和版权方有任何异议请及时告之，我们将妥善解决。
- 2.本站提供的中文数据手册是英文数据手册的中文翻译，其目的是协助用户阅读，该译文无法自动跟随原稿更新，同时也可能存在翻译上的不当。建议读者以英文原稿为参考以便获得更精准的信息。
- 3.本站提供的产品资料，来自厂商的技术支持或者使用者的心得体会等，其内容可能存在描述上的差异，建议读者做出适当判断。
- 4.如需与我们联系，请发邮件到marketing@iczoom.com，主题请标有“数据手册”字样。

## Read Statement

1. The datasheets and other product information on the site are all from network reference or other public materials, and the copyright belongs to the original author and original published source. If readers and copyright owners have any objections, please contact us and we will deal with it in a timely manner.
2. The Chinese datasheets provided on the website is a Chinese translation of the English datasheets. Its purpose is for reader's learning exchange only and do not involve commercial purposes. The translation cannot be automatically updated with the original manuscript, and there may also be improper translations. Readers are advised to use the English manuscript as a reference for more accurate information.
3. All product information provided on the website refer to solutions from manufacturers' technical support or users the contents may have differences in description, and readers are advised to take the original article as the standard.
4. If you have any questions, please contact us at marketing@iczoom.com and mark the subject with "Datasheets" .

# Connector for microSD™ Card (Push-push Type)

SCHA Series



Compact low-profile type most suitable for mobile phones.

For SD Memory Card

For microSD™ Card

For SIM Card 8pins

For W-SIM

For Memory Stick Micro™

For Memory Stick™

Combine Type

For Compact Flash™

For CMOS Camera Module

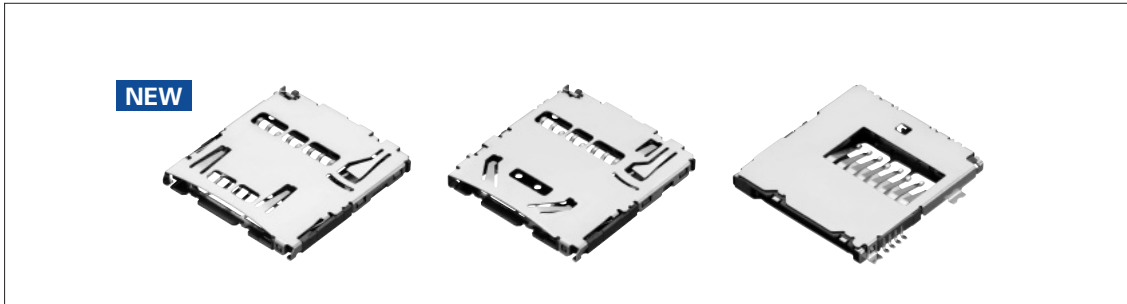

## Typical Specifications

Items		Specifications	
Structure	Applicable media	microSD™ Card	
	Mounting type	Surface mounting type	
	Mounting style	Standard mount/ Reverse mount	
	Media ejection structure	Push-push type	
Performance	Operating temperature range	-20°C to +70°C	
	Voltage proof	500V AC 1minute	
	Insulation resistance (Initial)	1,000MΩ min.	
	Contact resistance (Initial)	Connector contacts	100mΩ max.
		Detection switch	500mΩ max.
Insertion and removal cycle	5,000cycles		

## Product Line

Media ejection structure	Mounting system	Features	Stand-off (mm)	Packing system	Product No.	Drawing No.
Push-push type	Standard mount	With switch	0	Taping	SCHA4B0100	1
		With switches and fly-out protection.			SCHA4B0400	2
	Reverse mount	With switch			SCHA5B0200	3

## Packing Specifications

Taping Unit:mm

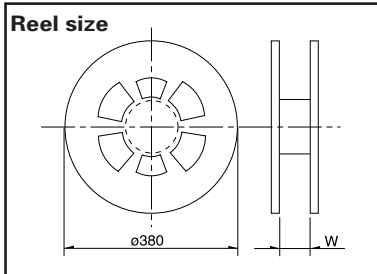

Product No.	Number of packages (pcs.)			Reel width W (mm)	Tape width (mm)	Export package measurements (mm)
	1 reel	1 case /Japan	1 case /export packing			
SCHA4B0100	2,000	6,000	12,000	24.4	24	403×403×249
SCHA4B0400						
SCHA5B0200	1,500	4,500	9,000			

**Dimensions**  
Standard mount

Unit:mm

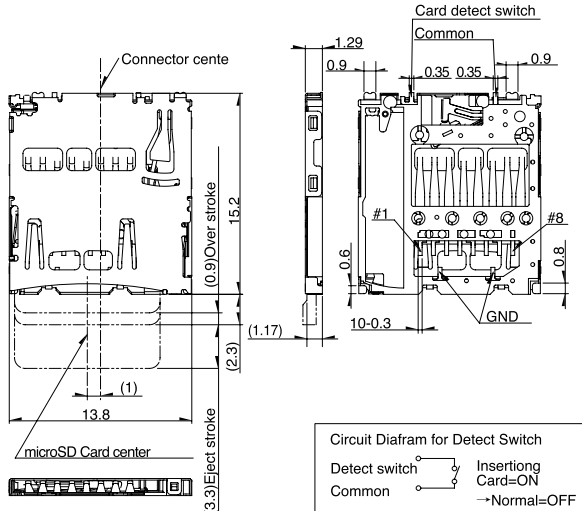
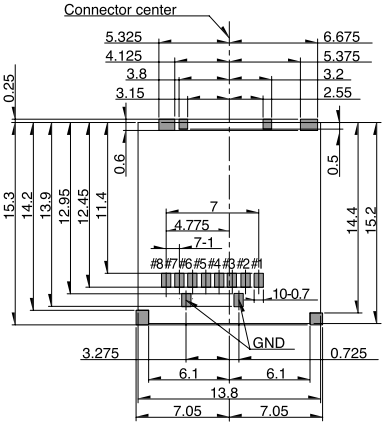
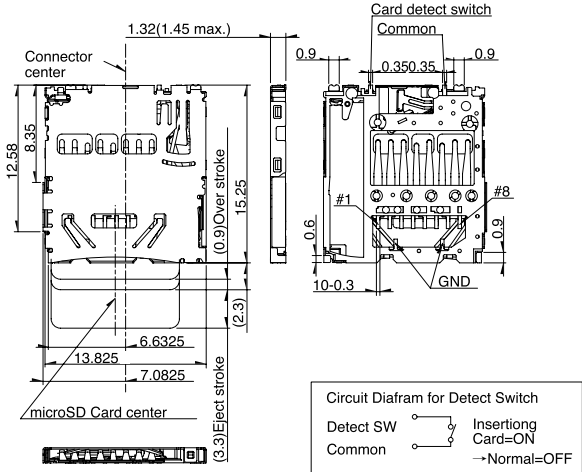
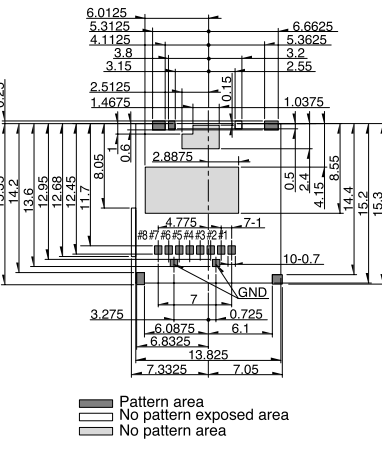
No.	Style	PC board mounting hole dimensions (Viewed from the mounting face side)																				
1	<p><b>With switch</b></p>  <table border="1" data-bbox="630 996 901 1108"> <thead> <tr> <th>PIN</th> <th>SD Mode</th> <th>PIN</th> <th>SD Mode</th> </tr> </thead> <tbody> <tr> <td>#1</td> <td>DAT2</td> <td>#5</td> <td>CLK</td> </tr> <tr> <td>#2</td> <td>DAT3/CD</td> <td>#6</td> <td>V<sub>SS</sub></td> </tr> <tr> <td>#3</td> <td>CMD</td> <td>#7</td> <td>DAT0</td> </tr> <tr> <td>#4</td> <td>V<sub>DD</sub></td> <td>#8</td> <td>DAT1</td> </tr> </tbody> </table> <p>Pin assignments</p>	PIN	SD Mode	PIN	SD Mode	#1	DAT2	#5	CLK	#2	DAT3/CD	#6	V <sub>SS</sub>	#3	CMD	#7	DAT0	#4	V <sub>DD</sub>	#8	DAT1	 <p>Legend:  <span style="display:inline-block; width:10px; height:10px; background-color:gray; border:1px solid black;"></span> Pattern Area  <span style="display:inline-block; width:10px; height:10px; border:1px solid black;"></span> NO Pattern Area</p>
PIN	SD Mode	PIN	SD Mode																			
#1	DAT2	#5	CLK																			
#2	DAT3/CD	#6	V <sub>SS</sub>																			
#3	CMD	#7	DAT0																			
#4	V <sub>DD</sub>	#8	DAT1																			
2	<p><b>With switches and fly-out protection.</b></p>  <table border="1" data-bbox="630 1724 901 1814"> <thead> <tr> <th>PIN</th> <th>SD Mode</th> <th>PIN</th> <th>SD Mode</th> </tr> </thead> <tbody> <tr> <td>#1</td> <td>DAT2</td> <td>#5</td> <td>CLK</td> </tr> <tr> <td>#2</td> <td>DAT3/CD</td> <td>#6</td> <td>V<sub>SS</sub></td> </tr> <tr> <td>#3</td> <td>CMD</td> <td>#7</td> <td>DAT0</td> </tr> <tr> <td>#4</td> <td>V<sub>DD</sub></td> <td>#8</td> <td>DAT1</td> </tr> </tbody> </table> <p>Pin assignments</p>	PIN	SD Mode	PIN	SD Mode	#1	DAT2	#5	CLK	#2	DAT3/CD	#6	V <sub>SS</sub>	#3	CMD	#7	DAT0	#4	V <sub>DD</sub>	#8	DAT1	 <p>Legend:  <span style="display:inline-block; width:10px; height:10px; background-color:gray; border:1px solid black;"></span> Pattern area  <span style="display:inline-block; width:10px; height:10px; border:1px solid black;"></span> No pattern exposed area  <span style="display:inline-block; width:10px; height:10px; background-color:lightgray; border:1px solid black;"></span> No pattern area</p>
PIN	SD Mode	PIN	SD Mode																			
#1	DAT2	#5	CLK																			
#2	DAT3/CD	#6	V <sub>SS</sub>																			
#3	CMD	#7	DAT0																			
#4	V <sub>DD</sub>	#8	DAT1																			

For SD Memory Card

For microSD™ Card

For SIM Card 8pins

For W-SIM

For Memory Stick Micro™

For Memory Stick™

Combine Type

For Compact Flash™

For CMOS Camera Module

**Dimensions**  
Reverse mount

Unit:mm

- For SD Memory Card
- For microSD™ Card
- For SIM Card 8pins
- For W-SIM
- For Memory Stick Micro™
- For Memory Stick™
- Combine Type
- For Compact Flash™
- For CMOS Camera Module

No.	Style	PC board mounting hole dimensions (Viewed from the mounting face side)																				
<b>3</b>	<p><b>Slim type with switch</b></p> <p>Connector center microSD Card center</p> <p>(0.875)</p> <p>(0.9)Over stroke</p> <p>(2.6)</p> <p>(3.3)Eject stroke</p> <p>Circuit Diafram for Detect Switch                      Detect Switch  Inserting Card=ON                      Common  →Normal=OFF</p> <p>Pin assignments</p> <table border="1" style="margin-left: auto; margin-right: auto;"> <thead> <tr> <th>PIN</th> <th>SD Mode</th> <th>PIN</th> <th>SD Mode</th> </tr> </thead> <tbody> <tr> <td>#1</td> <td>DAT2</td> <td>#5</td> <td>CLK</td> </tr> <tr> <td>#2</td> <td>DAT3/CD</td> <td>#6</td> <td>V<sub>SS</sub></td> </tr> <tr> <td>#3</td> <td>CMD</td> <td>#7</td> <td>DAT0</td> </tr> <tr> <td>#4</td> <td>V<sub>DD</sub></td> <td>#8</td> <td>DAT1</td> </tr> </tbody> </table>	PIN	SD Mode	PIN	SD Mode	#1	DAT2	#5	CLK	#2	DAT3/CD	#6	V <sub>SS</sub>	#3	CMD	#7	DAT0	#4	V <sub>DD</sub>	#8	DAT1	<p>Externals</p> <p>NO Pattern Area Land Area P.C.B cut on the point of CARD interference.</p>
PIN	SD Mode	PIN	SD Mode																			
#1	DAT2	#5	CLK																			
#2	DAT3/CD	#6	V <sub>SS</sub>																			
#3	CMD	#7	DAT0																			
#4	V <sub>DD</sub>	#8	DAT1																			

## Soldering Conditions

### Example of Reflow Soldering Condition (Reference)

1. Heating method: Double heating method with infrared heater.
2. Temperature measurement: Thermocouple 0.1 to 0.2 ϕ CA (K) or CC (T).
3. Temperature profile (Surface of products).

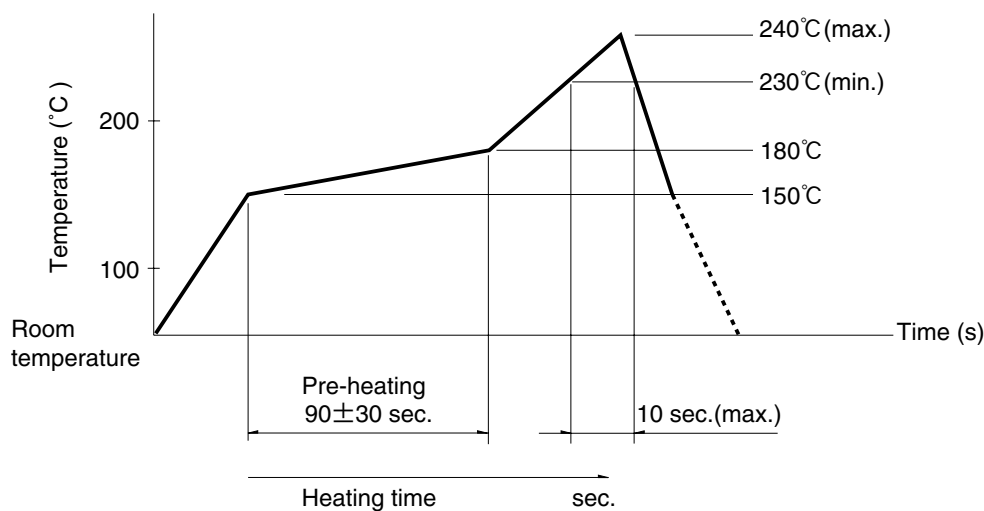

## Cautions for using this product

1. When soldering terminals, there is a danger that load placed on the terminals may cause rattle, deformation or electrical degradation to occur depending on the conditions. Caution is therefore required.
2. Avoid use of water-soluble soldering flux, since it may corrode the product.
3. Check and conform to reflow soldering requirements under actual mass production conditions.
4. PC board warping may alter the characteristics. Please take this into consideration when designing patterns and layout.
5. The card specifications are provided by the above manufactures. Products by other manufactures may not be compliant with these specifications and are subject to change without prior notice.

For SD Memory Card

For microSD™ Card

For SIM Card 8pins

For W-SIM

For Memory Stick Micro™

For Memory Stick™

Combine Type

For Compact Flash™

For CMOS Camera Module

# Mouser Electronics

Authorized Distributor

Click to View Pricing, Inventory, Delivery & Lifecycle Information:

ALPS:

[SCHA4B0400](#) [SCHA5B0200](#) [SCHA1B0100](#) [SCHA4B0100](#) [SCHA1A0101](#) [SCHA2B0300](#)