

阅读申明

- 1.本站收集的数据手册和产品资料都来自互联网，版权归原作者所有。如读者和版权方有任何异议请及时告之，我们将妥善解决。
- 2.本站提供的中文数据手册是英文数据手册的中文翻译，其目的是协助用户阅读，该译文无法自动跟随原稿更新，同时也可能存在翻译上的不当。建议读者以英文原稿为参考以便获得更精准的信息。
- 3.本站提供的产品资料，来自厂商的技术支持或者使用者的心得体会等，其内容可能存在描述上的差异，建议读者做出适当判断。
- 4.如需与我们联系，请发邮件到marketing@iczoom.com，主题请标有“数据手册”字样。

Read Statement

1. The datasheets and other product information on the site are all from network reference or other public materials, and the copyright belongs to the original author and original published source. If readers and copyright owners have any objections, please contact us and we will deal with it in a timely manner.
2. The Chinese datasheets provided on the website is a Chinese translation of the English datasheets. Its purpose is for reader's learning exchange only and do not involve commercial purposes. The translation cannot be automatically updated with the original manuscript, and there may also be improper translations. Readers are advised to use the English manuscript as a reference for more accurate information.
3. All product information provided on the website refer to solutions from manufacturers' technical support or users the contents may have differences in description, and readers are advised to take the original article as the standard.
4. If you have any questions, please contact us at marketing@iczoom.com and mark the subject with "Datasheets".



AIRPAX® | ATR20 Series

Thermal Circuit Protector for Equipment

FEATURES

- RoHS compliant, single pole, thermal current overload protector
- Reliable, trip-free operation on current overloads
- Warranty: 24-months from date of manufacture
- Protection range and operating voltage:
0.1 to 16.0 Amps, 240 VAC, 50 VDC (cRUus,cCSAus)
0.5 to 12 Amps, 240 VAC, 24 VDC (VDE)

DESCRIPTION

The Airpax™ ATR20 product family is a single pole, thermally operated overload protector with a snap-acting trip mechanism that provides reliable, trip-free operation on current overloads. The ATR20 series is designed with multiple mounting configurations including central nut and wing clip.

SPECIFICATIONS

| | |
|---|---|
| Standard Current Ratings | 2.5, 3, 4, 5, 6, 7, 8, 10, 12, 15, 16, 20 Amps (AC - inductive, DC - resistive) |
| Voltage Ratings | 125 / 250 VAC, 50/60 Hz, 50 VDC |
| Max Breaking Capacity | 8x I _n for < 6A, 60A max. > 6A |
| Conditional Short Circuit Capacity Inc1 (PC1) per EN 60934 | 1000A 125 / 250VAC, 50VDC, SC:1kA, C1, 125 / 250VAC, 50VDC Ref. CSA 22.2 No. 235-04, UL 1077 |
| Rated Short Circuit Capacity I _{cn} Ref. EN 60934 | Min. 6 X Rated Current (6 X I _n), 250VAC inductive Min. 4 X Rated Current (4 X I _n), 50VDC resistive |
| Tripping Current Code (TC) | TC2 ref: CSA22.2, No. 235-04 |
| Insulation Resistance | Min 100 MΩ @ 500VDC |
| Dielectric Strength | 1.5 KV for 1 min. (per EN60934) |
| Initial Withstand Voltage | 2.5 KV (per EN60934) |
| Operational Life | 1000 Cycles @ 2 x I _n |
| Overload Rating | OL0 240Vac, 50Vdc, ref: CSA22.2, No. 235-04 |
| Overload Switching Capacity | 6x I _n AC Up to 9A, 4x I _n DC Up to 12A 60A Max. from 10A to 12A |
| Max Operating Temperature | 60°C (140°F) Ambient |
| Application Type | General Industrial ref: CSA22.2, No. 235-04 |
| Method of Tripping | Thermal "TO", trip-free |
| Type of Actuation | Reset button, type "R" |
| Weight | Approximately 17 grams |
| Applicable Approvals | UL 1077, CSA 22.2 No. 235-04, TÜV EN 60934 |

TIME / CURRENT CHARACTERISTICS

The standard characteristic is valid for an ambient temperature of 25°C. However, if the device is to be used in an ambient temperature other than 25°C, an allowance must be made when selecting the current rating.

See the charts, graph and example below to help determine the right circuit protector rating for your application.

AMBIENT TEMPERATURE CORRECTION FACTOR - 2.5 AMP CIRCUIT PROTECTOR

| Ambient Temperature (°C) | - 20 | - 10 | 0 | + 10 | + 25 | + 30 |
|--------------------------|------|------|-----|------|------|------|
| Multiplication Factor | 0.58 | 0.6 | 0.7 | 0.8 | 1 | 1 |

AMBIENT TEMPERATURE CORRECTION FACTOR - 3 AMP TO 4 AMP CIRCUIT PROTECTOR

| Ambient Temperature (°C) | - 20 | - 10 | 0 | + 10 | + 25 | + 30 | + 35 |
|--------------------------|------|------|-----|------|------|------|------|
| Multiplication Factor | 0.8 | 0.85 | 0.9 | 0.9 | 1 | 1 | 1.1 |

AMBIENT TEMPERATURE CORRECTION FACTOR - 5 AMP TO 20 AMP CIRCUIT PROTECTOR

| Ambient Temperature (°C) | - 20 | - 10 | 0 | + 10 | + 25 | + 40 | + 50 | + 60 |
|--------------------------|------|------|------|------|------|------|------|------|
| Multiplication Factor | 0.8 | 0.85 | 0.88 | 0.9 | 1 | 1.1 | 1.3 | 1.4 |

Example :

Normal Continuous Current = 5.0 A

Ambient Temperature = 40°C

Multiplication Factor = 1.1 (from 3rd chart)

Recommended Rating: $5.0 \times 1.1 = 5.5$

Select the Nearest Rating = 6.0 amps (nearest)

Operating Characteristics :

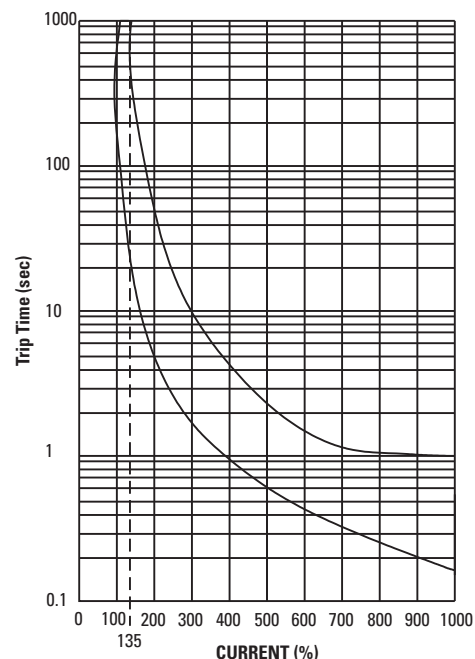

MOUNTING OPTIONS, inches [mm]

Central Mounting (A)

A. 3/8" - 27 UNS Thread

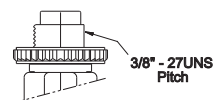
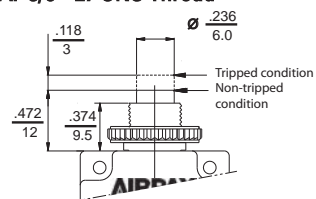

Panel cutout

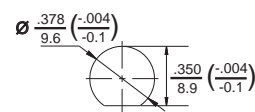

Central Mounting (C)

C. M 11 Thread

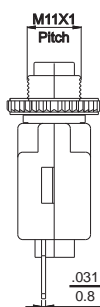
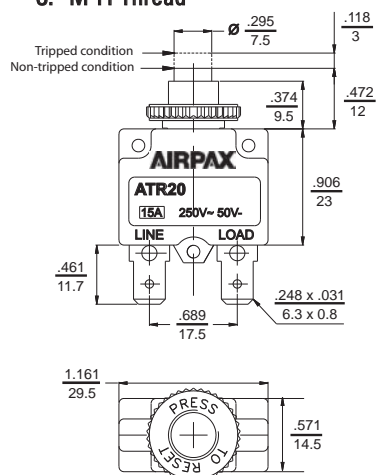

Panel cutout

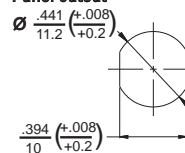

Wing Clips (W)

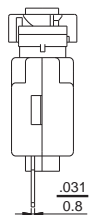
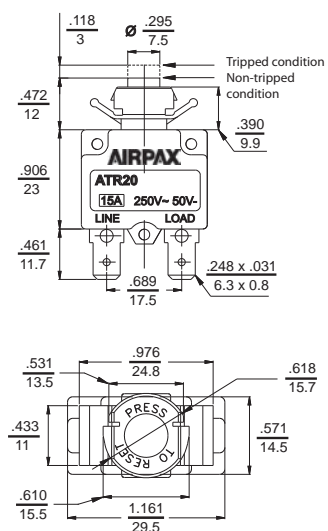

Panel cutout

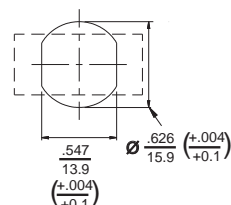

ADDITIONAL OPTIONS

Terminals

S. STRAIGHT

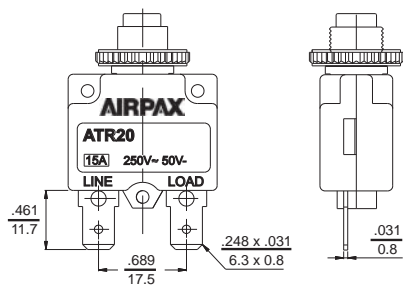

L. 90° BEND, LEFT SIDE

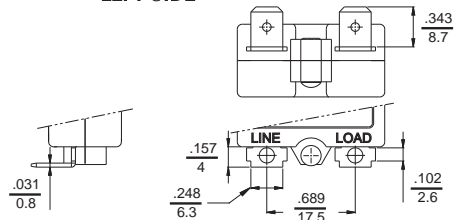

R. 90° BEND, RIGHT SIDE

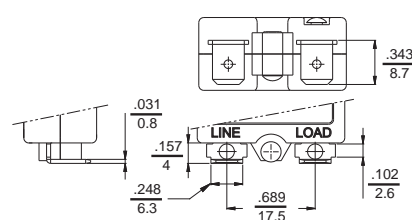

Button Marking

VERTICAL

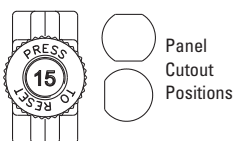

Mounting Nuts

PLASTIC KNURLED NUT (P/N 053-200-0001)



METAL KNURLED NUT (P/N 053-200-0002)

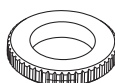

METAL HEXAGONAL NUT (P/N 053-200-0003)



Accessories

DUST COVER METAL KNURLED NUT (053-200-0005)



HORIZONTAL

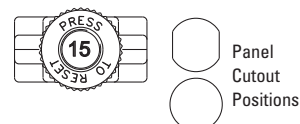

Indicator Plate



TYPES:
1. Embossed (Aluminium) (P/N 053-200-0004)
2. Silver Letters on Black (P/N 053-200-0007)

DECISION TABLES

ATR20 - C - 63 S - B 1 - A - 7.0A - 2

Product Type

2 Mounting Bushing

A Plastic 3/8"-27
C Plastic M11
W Wing Clip

4 Terminal Options

S Straight
L 90° Bend, Left Side
R 90° Bend, Right Side

6 Button Marking

0 None
1 White, Vertical
2 Black, Vertical
3 White, Horizontal
4 Black, Horizontal

8 Std. Current Rating

2.5, 3.0, 4.0, 5.0, 6.0,
7.0, 8.0, 10.0, 12.0,
15.0, 16.0, 20.0

3 Terminal Size

63 .250

5 Button Color

B Black
WB White with trip indication

7 Mounting Nut

N None or Wing Clip
A Plastic Knurled
B Metal Knurled
C Metal Hex Nut
D Sealing Knurled Boot

9 Indicator Plate

0 None
1 Embossed Aluminium
2 Silver Letters on Black