

## 阅读申明

- 1.本站收集的数据手册和产品资料都来自互联网，版权归原作者所有。如读者和版权方有任何异议请及时告之，我们将妥善解决。
- 2.本站提供的中文数据手册是英文数据手册的中文翻译，其目的是协助用户阅读，该译文无法自动跟随原稿更新，同时也可能存在翻译上的不当。建议读者以英文原稿为参考以便获得更精准的信息。
- 3.本站提供的产品资料，来自厂商的技术支持或者使用者的心得体会等，其内容可能存在描述上的差异，建议读者做出适当判断。
- 4.如需与我们联系，请发邮件到marketing@iczoom.com，主题请标有“数据手册”字样。

## Read Statement

1. The datasheets and other product information on the site are all from network reference or other public materials, and the copyright belongs to the original author and original published source. If readers and copyright owners have any objections, please contact us and we will deal with it in a timely manner.
2. The Chinese datasheets provided on the website is a Chinese translation of the English datasheets. Its purpose is for reader's learning exchange only and do not involve commercial purposes. The translation cannot be automatically updated with the original manuscript, and there may also be improper translations. Readers are advised to use the English manuscript as a reference for more accurate information.
3. All product information provided on the website refer to solutions from manufacturers' technical support or users the contents may have differences in description, and readers are advised to take the original article as the standard.
4. If you have any questions, please contact us at marketing@iczoom.com and mark the subject with "Datasheets" .

**Panasonic**  
ideas for life

**16A LOW PROFILE  
POWER RELAY**

**LZ RELAYS (ALZ)**

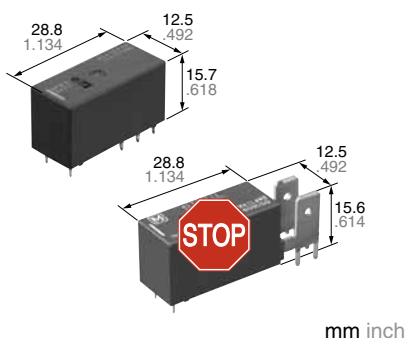

**FEATURES**

**1. Low profile type with height of 15.7 mm**

Slim, low profile type with dimensions of 28.8 (L) × 12.5 (W) × 15.7 (H) mm 1.134 (L) × .492 (W) × .618 (H) inch.

**2. High insulation resistance**

Superior insulation characteristics have been achieved by maintaining an insulation distance between coil and contacts of at least 10 mm for both creepage distance and clearances. Furthermore, anti-surge voltage is 10 kV and higher. (Supports European reinforced insulation requirement.)

**3. Superior heat resistance**

Can be used in ambient temperatures up to 85°C 185°F for the class B and 105°C 221°F for the class F.

**4. Low operating power**

Power saved with a nominal operating power of only 400 mW.

**5. Conforms to the various safety standards:**

UL, C-UL, VDE approved.

**6. Superior heat resistance and tracking resistance**

EN60335-1 GWT compliant (Tested by VDE) type available (Excluding TMP type)

**7. TMP type also available.**

**Compliance with RoHS Directive**

**SPECIFICATIONS**

**Contact**

Arrangement	1 Form A, 1 Form C and 1 Form A (TMP type)	
Initial contact resistance, max. (By voltage drop 6V DC 1A)	100mΩ	
Contact material	AgSnO <sub>2</sub> type	
Rating (resistive load)	Nominal switching capacity	16A 250V AC
	Max. switching power	4,000V A
	Max. switching voltage	440V AC
	Max. switching current	16A
	Min. switching capacity* <sup>1</sup> (Reference value)	100mA, 5V DC
Expected life (min. operations)	Mechanical (at 180 cpm)	1 Form A/1 Form C: 1 × 10 <sup>7</sup> 1 Form A (TMP type) 5 × 10 <sup>6</sup>
	Electrical (at 20 cpm) (Rated load)	1 Form A/1 Form C: N.O.: 10 <sup>5</sup> , N.C.: 5 × 10 <sup>4</sup> 1 Form A (TMP type) 10 <sup>5</sup>

**Coil**

Nominal operating power	400mW
-------------------------	-------

#1 This value can change due to the switching frequency, environmental conditions, and desired reliability level, therefore it is recommended to check this with the actual load.

**Remarks**

- \* Specifications will vary with foreign standards certification ratings.
- \*<sup>1</sup> Measurement at same location as "Initial breakdown voltage" section.
- \*<sup>2</sup> Detection current: 10mA
- \*<sup>3</sup> Wave is standard shock voltage of ±1.2 × 50μs according to JEC-212-1981
- \*<sup>4</sup> Excluding contact bounce time.
- \*<sup>5</sup> Half-wave pulse of sine wave: 11 ms; detection time: 10 μs
- \*<sup>6</sup> Half-wave pulse of sine wave: 6 ms
- \*<sup>7</sup> Detection time: 10 μs
- \*<sup>8</sup> The upper limit of the ambient temperature is the maximum temperature that can satisfy the coil temperature rise value. Refer to 6. Conditions for operation, transport and storage mentioned in AMBIENT ENVIRONMENT.
- \*<sup>9</sup> Class F type is ambient temperature 105°C 221°F.
- \*Please note that some of the specifications listed above may not comply with overseas standards.

**Characteristics**

Max. operating speed		20 cpm (at rated load)
Initial insulation resistance* <sup>1</sup>		Min. 1,000 MΩ (at 500V DC)
Initial breakdown voltage* <sup>2</sup>	Between open contacts	1,000 Vrms for 1 min.
	Between contacts and coil	5,000 Vrms for 1 min.
Initial surge voltage between contact and coil* <sup>3</sup>		10,000 V
Operate time* <sup>4</sup> (at nominal voltage)		Max. 15ms (at 20°C 68°F)
Release time (without diode)* <sup>4</sup> (at nominal voltage)		Max. 5ms (at 20°C 68°F)
Temperature rise (20°C 68°C)		Max. 55°C with nominal coil voltage and at 16A contact carrying current (resistance method)
Shock resistance	Functional* <sup>5</sup>	100 m/s <sup>2</sup> {approx. 10 G}
	Destructive* <sup>6</sup>	1,000 m/s <sup>2</sup> {approx. 100 G}
Vibration resistance	Functional* <sup>7</sup>	1 Form A/1 Form C: 10 to 55Hz at double amplitude of 0.8mm 1 Form A (TMP type): 10 to 55Hz at double amplitude of 1.5mm
	Destructive	10 to 55Hz at double amplitude of 1.5mm
Conditions for operation, transport and storage* <sup>8</sup> (Not freezing and condensing at low temperature)	Ambient temp.	-40°C to +85°C -40°F to +185°F (Class B)* <sup>9</sup>
	Humidity	5 to 85% R.H.
Unit weight		1 Form A/1 Form C: Approx. 12 g .42 oz 1 Form A (TMP type): Approx. 13 g .46 oz

# LZ (ALZ)

## TYPICAL APPLICATIONS

- |   |   |   |
|---|---|---|
| 1) Household electrical appliances<br>TV, CATV, Audio equipment, Microwave ovens, and Heaters, etc. | 2) Office equipment<br>Copy machines, Packaged air conditioners, and Vending machines | 3) Industrial equipment<br>Machine tools, Robots, and Temperature controllers |
|---|---|---|

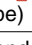

## ORDERING INFORMATION

Ex. A LZ 1 1 B 12  W

Product name	Contact arrangement	Protective construction	Coil insulation class	Coil voltage,* V DC	Flame resistance and tracking resistance	Packing style
LZ	1: 1 Form C 2: 1 Form A  7: 1 Form A  (TMP type)	1: Flux-resistant type	B: Class B insulation F: Class F insulation	05: 5    18: 18 09: 9    24: 24 12: 12    48: 48	Nil: — T: EN60335-1 (Conform) (Excluding TMP type.)	W: Carton packing

- Notes: 1. Only 1 Form C and 1 Form A types are available for 48 V (excluding TMP type).  
 2. UL, C-UL, VDE approved type is standard.  
 3. Sealed type is also available. (Excluding TMP type.) Please consult us.  
 4. If you desire tube packaging, please order without adding the packaging symbol "W" to the end of the part number.

## TYPES

Contact arrangement	Coil voltage, V DC	Carton packing	
		Class B	Class F
1 Form C	5	ALZ11B05W	ALZ11F05W
	9	ALZ11B09W	ALZ11F09W
	12	ALZ11B12W	ALZ11F12W
	18	ALZ11B18W	ALZ11F18W
	24	ALZ11B24W	ALZ11F24W
	48	ALZ11B48W	ALZ11F48W
 1 Form A	5	ALZ21B05W	ALZ21F05W
	9	ALZ21B09W	ALZ21F09W
	12	ALZ21B12W	ALZ21F12W
	18	ALZ21B18W	ALZ21F18W
	24	ALZ21B24W	ALZ21F24W
	48	ALZ21B48W	ALZ21F48W
 1 Form A (TMP type)	5	ALZ71B05W	ALZ71F05W
	9	ALZ71B09W	ALZ71F09W
	12	ALZ71B12W	ALZ71F12W
	18	ALZ71B18W	ALZ71F18W
	24	ALZ71B24W	ALZ71F24W

- Notes: 1. Tube packing: Inner carton: 20pcs.; Case: 800pcs.  
 2. Carton packing: Inner carton: 100pcs.; Case: 500pcs.  
 3. If you desire tube packaging, please order without adding the packaging symbol "W" to the end of the part number. (Note that only carton packaging is possible for 1 Form A TMP type.)  
 4. Carton packing symbol "W" is not marked on the relay.  
 5. EN60335-1 GWT compliant types available. When ordering, please add suffix "T". (EN60335-1 GWT compliant type is not available for the TMP types.)  
 Ex. ALZ21B12I, ALZ21F12IW

## COIL DATA

Nominal voltage, V DC	Pick-up voltage, V DC (max.)	Drop-out voltage, V DC (min.)	Coil resistance, Ω (±10%)	Nominal operating current, mA (±10%)	Nominal operating power, mW	Maximum allowable voltage, V DC
5	3.5	0.5	63	80	400	6.5
9	6.3	0.9	203	44.4		11.7
12	8.4	1.2	360	33.3		15.6
18	12.6	1.8	810	22.2		23.4
24	16.8	2.4	1,440	16.7		31.2
48*	33.6	4.8	5,760	8.3		62.4

\* Only 1 Form C and 1 Form A types are available for 48 V (excluding TMP type).

**DIMENSIONS**

**1. 1 Form A type**

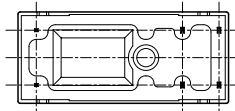
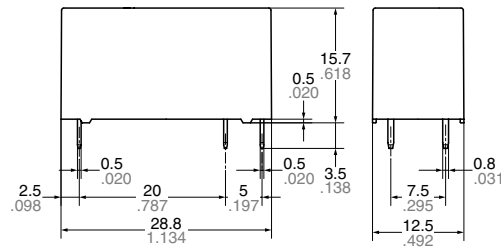

PC board pattern

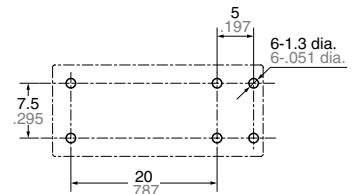

Tolerance:  $\pm 0.1 \pm 0.004$

Schematic (Bottom view)

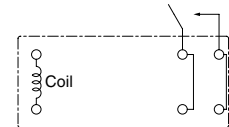

**2. 1 Form C type**

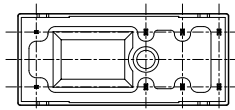
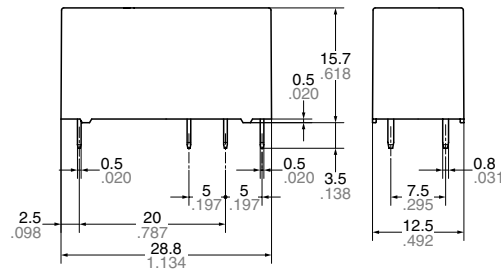

PC board pattern

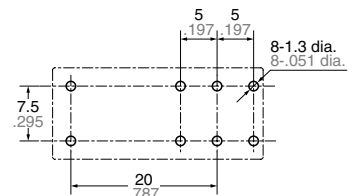

Tolerance:  $\pm 0.1 \pm 0.004$

Schematic (Bottom view)

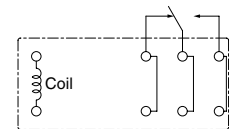

**3. 1 Form A (TMP type)**

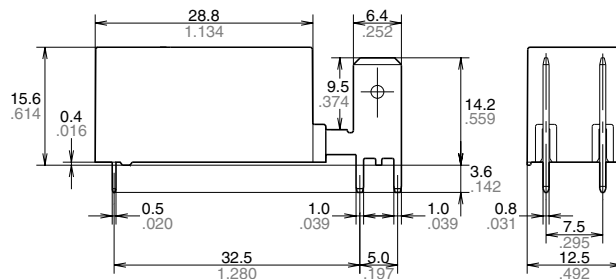

PC board pattern

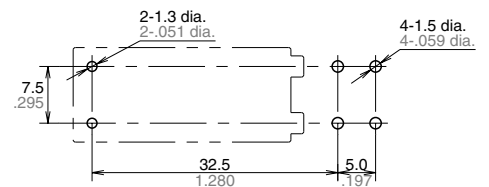

Tolerance:  $\pm 0.1 \pm 0.004$

Schematic (Bottom view)



# LZ (ALZ)

## REFERENCE DATA

1. Max. switching power (AC resistive load)

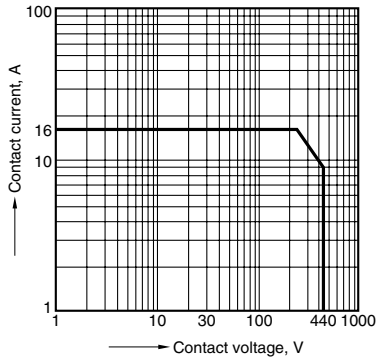

2. Max. switching power (DC resistive load)

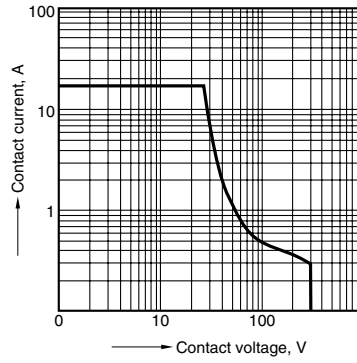

3. Coil temperature rise

Sample: ALZ11F12, 5pcs.  
Measured portion: coil inside  
Contact current: 0 A, 16 A

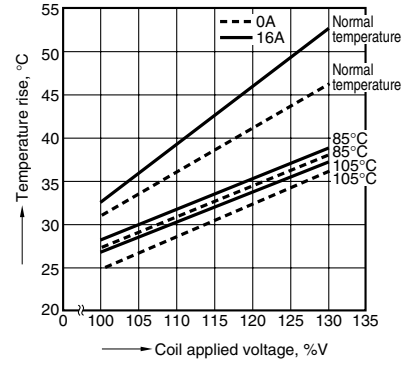

**For Cautions for Use, see Relay Technical Information.**