

阅读申明

- 1.本站收集的数据手册和产品资料都来自互联网，版权归原作者所有。如读者和版权方有任何异议请及时告之，我们将妥善解决。
- 2.本站提供的中文数据手册是英文数据手册的中文翻译，其目的是协助用户阅读，该译文无法自动跟随原稿更新，同时也可能存在翻译上的不当。建议读者以英文原稿为参考以便获得更精准的信息。
- 3.本站提供的产品资料，来自厂商的技术支持或者使用者的心得体会等，其内容可能存在描述上的差异，建议读者做出适当判断。
- 4.如需与我们联系，请发邮件到marketing@iczoom.com，主题请标有“数据手册”字样。

Read Statement

1. The datasheets and other product information on the site are all from network reference or other public materials, and the copyright belongs to the original author and original published source. If readers and copyright owners have any objections, please contact us and we will deal with it in a timely manner.
2. The Chinese datasheets provided on the website is a Chinese translation of the English datasheets. Its purpose is for reader's learning exchange only and do not involve commercial purposes. The translation cannot be automatically updated with the original manuscript, and there may also be improper translations. Readers are advised to use the English manuscript as a reference for more accurate information.
3. All product information provided on the website refer to solutions from manufacturers' technical support or users the contents may have differences in description, and readers are advised to take the original article as the standard.
4. If you have any questions, please contact us at marketing@iczoom.com and mark the subject with "Datasheets" .

COUNT	DESCRIPTION OF REVISIONS	BY	CHKD	DATE	COUNT	DESCRIPTION OF REVISIONS	BY	CHKD	DATE
△					△				
△					△				

APPLICABLE STANDARD				
RATING	OPERATING TEMPERATURE RANGE	-40 °C TO +90°C(90%RH MAX)	STORAGE TEMPERATURE RANGE	-40 °C TO +90°C(90%RH MAX)
	POWER	_____ W	CHARACTERISTIC IMPEDANCE	75 Ω (0 TO 1.5 GHz)
	PECULIARITY	_____	APPLICABLE CABLE	CO-6FPFA-SB-CX75 1×0.16 :HITACHI CABLE CO.,LTD.
	RATED VOLTAGE	_____		

SPECIFICATIONS				
ITEM	TEST METHOD	REQUIREMENTS	QT	AT

CONSTRUCTION				
GENERAL EXAMINATION	VISUALLY AND BY MEASURING INSTRUMENT.	ACCORDING TO DRAWING.	<input type="checkbox"/>	<input type="checkbox"/>
MARKING	CONFIRMED VISUALLY.		<input type="checkbox"/>	<input type="checkbox"/>

ELECTRIC CHARACTERISTICS				
CONTACT RESISTANCE	10 mA MAX (DC OR 1000 Hz).	CENTER CONTACT 2.15(L-1.6)+40 mΩ MAX.	<input type="checkbox"/>	<input type="checkbox"/>
		OUTER CONTACT 0.09(L-1.6)+20 mΩ MAX.	<input type="checkbox"/>	<input type="checkbox"/>
INSULATION RESISTANCE	250 V DC.	500 MΩ MIN.	<input type="checkbox"/>	<input type="checkbox"/>
VOLTAGE PROOF	300 V AC FOR 1 min.(CURRENT LEAKAGE 2mA MAX.)	NO FLASHOVER OR BREAKDOWN.	<input type="checkbox"/>	<input type="checkbox"/>
VOLTAGE STANDING WAVE RATIO	FREQUENCY 0.045 TO 1.5 GHz.	VSWR 1.25 MAX.	<input type="checkbox"/>	-
INSERTION LOSS	FREQUENCY _____ TO _____ GHz	_____ dB MAX.	-	-

MECHANICAL CHARACTERISTICS				
CABLE CLAMP ROBUSTNESS (AGAINST CABLE PULL)	APPLYING A PULL FORCE THE CABLE AXIALLY AT 14.7 N MAX.	① NO WITHDRAWAL AND BREAKAGE OF CABLE. ② NO BREAKAGE OF CLAMP.	<input type="checkbox"/>	-
<p>FOR REFERENCE ONLY</p> <p>Subject to change without notice</p>				

REMARKS	DRAWN	DESIGNED	CHECKED	APPROVED	RELEASED
NOTE 1. L : CABLE LENGTH (mm)	<i>S. Yamane</i>	<i>S. Yamane</i>	<i>M. Yamane</i>	<i>Kobayashi</i>	
Unless otherwise specified, refer to JIS C 5402.	98.6.23	98.6.23	98.6.23	98.6.23	

Note QT:Qualification Test AT:Assurance Test ○:Applicable Test			PART NO.	
HRS HIROSE ELECTRIC CO., LTD.		SPECIFICATION SHEET		H.FL75-2LP-084H-A-L
CODE NO.(OLD)	DRAWING NO.	PART NO.	1/1	
CL	ELC4-133538	CL321-2151-2		

TO
RF

1					2					3					4					
COUNT	DESCRIPTION OF REVISIONS	BY	CHKD	DATE	COUNT	DESCRIPTION OF REVISIONS	BY	CHKD	DATE	COUNT	DESCRIPTION OF REVISIONS	BY	CHKD	DATE	COUNT	DESCRIPTION OF REVISIONS	BY	CHKD	DATE	

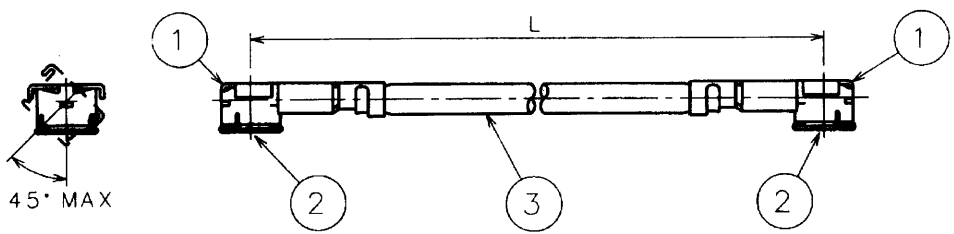

PART NO.	CODE NO.	L (mm)
H.FL75-2LP-084H-A-40	CL321-2151-2-01	40±4
H.FL75-2LP-084H-A-50	CL321-2151-2-02	50±4
H.FL75-2LP-084H-A-60	CL321-2151-2-03	60±4
H.FL75-2LP-084H-A-70	CL321-2151-2-04	70±4
H.FL75-2LP-084H-A-80	CL321-2151-2-05	80±4
H.FL75-2LP-084H-A-90	CL321-2151-2-06	90±4
H.FL75-2LP-084H-A-100	CL321-2151-2-07	100±4
H.FL75-2LP-084H-A-110	CL321-2151-2-08	110±4
H.FL75-2LP-084H-A-120	CL321-2151-2-09	120±4
H.FL75-2LP-084H-A-130	CL321-2151-2-10	130±4
H.FL75-2LP-084H-A-140	CL321-2151-2-11	140±4
H.FL75-2LP-084H-A-150	CL321-2151-2-12	150±4
H.FL75-2LP-084H-A-160	CL321-2151-2-13	160±4
H.FL75-2LP-084H-A-170	CL321-2151-2-14	170±4
H.FL75-2LP-084H-A-180	CL321-2151-2-15	180±4
H.FL75-2LP-084H-A-190	CL321-2151-2-16	190±4
H.FL75-2LP-084H-A-200	CL321-2151-2-17	200±4
H.FL75-2LP-084H-A-300	CL321-2151-2-18	300±8
H.FL75-2LP-084H-A-400	CL321-2151-2-19	400±8
H.FL75-2LP-084H-A-500	CL321-2151-2-20	500±8
H.FL75-2LP-084H-A-600	CL321-2151-2-21	600±12
H.FL75-2LP-084H-A-700	CL321-2151-2-22	700±12
H.FL75-2LP-084H-A-800	CL321-2151-2-23	800±12
H.FL75-2LP-084H-A-900	CL321-2151-2-24	900±12
H.FL75-2LP-084H-A-1000	CL321-2151-2-25	1000±12

[PRECAUTIONS FOR HANDLING]

- ◆Connector insertion and extraction
 - Connector shall be extracted vertically by specialised extraction JIG.
Part No.: H.FL-LP-N (CL Code: CL331-0551-7)
Never hold the cable when extracting the cable because it damages the connector.
 - Insert the connector as perpendicularly to the mating surface as possible by aligning the mating axes of both connectors. Do not excessively slant the connectors when inserting.

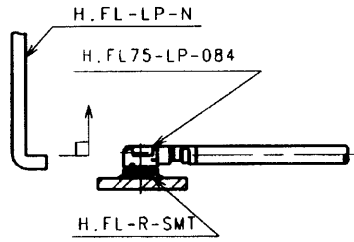

Cable length tolerance

L (mm)	Standard tolerance
35 ≤ L ≤ 200	±4 mm
200 < L ≤ 500	±8 mm
500 < L ≤ 1000	±12 mm
1000 < L	±1.5% mm

[DIMENSIONS OF CONNECTOR]

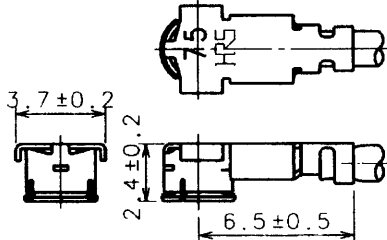

2	H.FL75-CONTACT	CL331-0550-4	3	CO-6FPFA-SB-CX75	HITACHI CABLE CO., LTD
1	H.FL75-LP-084(01)	CL331-0541-3-01			
NO.	PART NO.	CODE NO.	NO.	PART NO.	MANUFACTURER

CODE NO. (OLD) CL	DRAWN	DESIGNED	CHECKED	APPROVED	RELEASED
FOR REFERENCE ONLY Subject to change without notice	<i>M. Yamane</i>	<i>M. Yamane</i>	<i>M. Yamane</i>	<i>M. Kobayashi</i>	HRS 4.20.5 USA
	DATE: 98.6.23	DATE: 98.6.23	DATE: 98.6.23	DATE: 98.6.23	

SCALE FREE	DRAWING NO. EDC4-133538	PART NO. H.FL75-2LP-084H-A-L
UNITS mm	HRS HIROSE ELECTRIC CO., LTD.	CODE NO. CL321-2151-2

TO
RF