

阅读申明

- 1.本站收集的数据手册和产品资料都来自互联网，版权归原作者所有。如读者和版权方有任何异议请及时告之，我们将妥善解决。
- 2.本站提供的中文数据手册是英文数据手册的中文翻译，其目的是协助用户阅读，该译文无法自动跟随原稿更新，同时也可能存在翻译上的不当。建议读者以英文原稿为参考以便获得更精准的信息。
- 3.本站提供的产品资料，来自厂商的技术支持或者使用者的心得体会等，其内容可能存在描述上的差异，建议读者做出适当判断。
- 4.如需与我们联系，请发邮件到marketing@iczoom.com，主题请标有“数据手册”字样。

Read Statement

1. The datasheets and other product information on the site are all from network reference or other public materials, and the copyright belongs to the original author and original published source. If readers and copyright owners have any objections, please contact us and we will deal with it in a timely manner.
2. The Chinese datasheets provided on the website is a Chinese translation of the English datasheets. Its purpose is for reader's learning exchange only and do not involve commercial purposes. The translation cannot be automatically updated with the original manuscript, and there may also be improper translations. Readers are advised to use the English manuscript as a reference for more accurate information.
3. All product information provided on the website refer to solutions from manufacturers' technical support or users the contents may have differences in description, and readers are advised to take the original article as the standard.
4. If you have any questions, please contact us at marketing@iczoom.com and mark the subject with "Datasheets" .

.039" [1.00MM] CONTACT CENTERS

FEATURES

- * Accommodates .062 + - .008" PC board
(Consult factory for other board thicknesses)
- * PPS or PCT insulator
- * Molded-in key available
- * 1 amp current rating
- * Highly reliable high cycle hairpin bellow contacts
- * 150 grams normal force minimum

READOUT

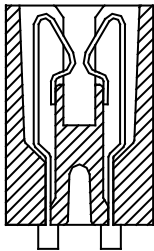

DUAL (D)

TERMINATION TYPE

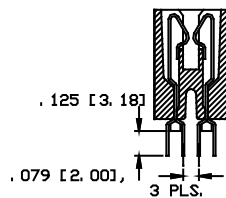

STAGGERED DIP
SOLDER (HH)

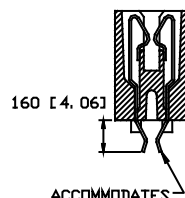

CARD EXTENDER
(HR)

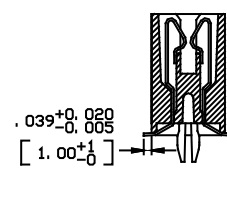

SURFACE MOUNT
(HF)

P.C.B. LAYOUTS

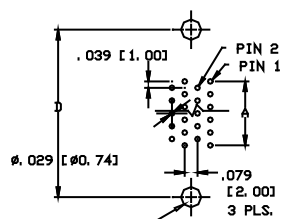

CONNECTOR SIDE

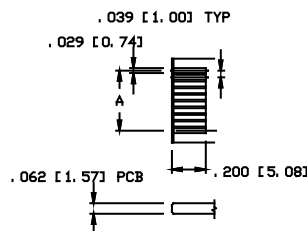

SOLDER END

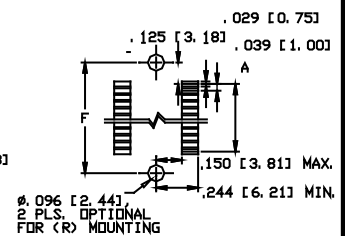

CONNECTOR SIDE

MOUNTING STYLE

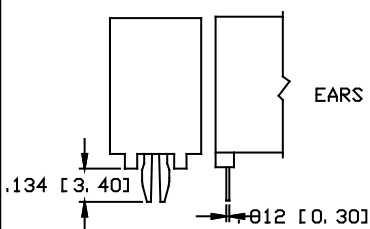

BOARD LOCK (R)

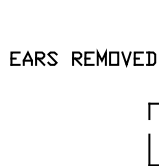

NO MOUNTING EARS (N)

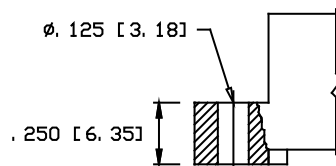

FLUSH MOUNTING (D)

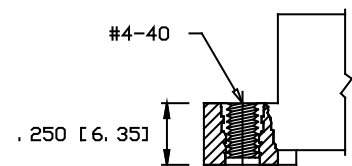

THREADED INSERT (T)

DIP SOLDER/CARD EXTENDER/SMT EDGE CARD CONNECTORS

PART NUMBER CODING

R Z E 50 D H H D -SXXX

MATERIALS (Insulator/Contact)
 R = PPS/Phosphor Bronze
 A = PPS/Beryllium Copper
 L = PCT/Phosphor Bronze
 M = PCT/Beryllium Copper

CONTACT FINISH
 Contact Surface Termination Underplate
 Z = .000010" Gold .000100" Tin .000050" Nickel
 X = .000030" Gold .000100" Tin .000050" Nickel

CONTACT CENTERS
 E = .039" [1.00 mm]

NUMBER OF CONTACT POSITIONS
 1 through 50

MODIFICATIONS (Consult Factory)
 Omit For Standard

MOUNTING STYLE (Opposite Page)
 D = Flush Mounting
 N = No Mounting
 R = Board Lock
 T = Flush Mounting With Threaded Insert

TERMINATION TYPE (Opposite Page)
 HH = Staggered Dip Solder
 HR = Card Extender
 HF = Surface Mount

READOUT (Opposite page)
 D = Dual

DIMENSIONS

Dimensions in [] are in millimeters, all others in inches.

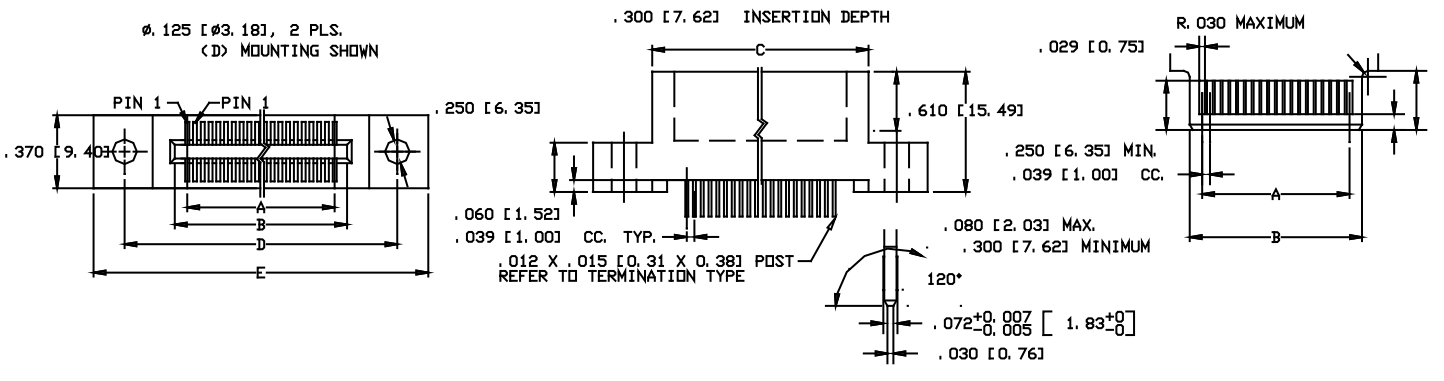

PART NUMBER	NUMBER OF CONTACTS	INCH										MM					
		A ±.005	B+.005-.000	C+.015	D+.010	E+.020	F+.010	A ±.13	B+.13-.00	C+.38	D+.25	E+.51	F+.25				
RZE01D	-	0.000	0.126	0.350	0.636	0.950	0.250	0.00	3.20	8.89	16.15	24.13	6.35				
RZE02D	-	0.039	0.165	0.389	0.675	0.989	0.289	1.00	4.20	9.89	17.15	25.13	7.35				
RZE03D	-	0.079	0.205	0.429	0.715	1.029	0.329	2.00	5.20	10.89	18.15	26.13	8.35				
RZE04D	-	0.118	0.244	0.468	0.754	1.068	0.368	3.00	6.20	11.89	19.15	27.13	9.35				
RZE05D	-	0.157	0.283	0.507	0.793	1.107	0.407	4.00	7.20	12.89	20.15	28.13	10.35				
RZE06D	-	0.197	0.323	0.547	0.833	1.147	0.447	5.00	8.20	13.89	21.15	29.13	11.35				
RZE07D	-	0.236	0.362	0.586	0.872	1.186	0.486	6.00	9.20	14.89	22.15	30.13	12.35				
RZE08D	-	0.276	0.402	0.626	0.912	1.226	0.526	7.00	10.20	15.89	23.15	31.13	13.35				
RZE09D	-	0.315	0.441	0.665	0.951	1.265	0.565	8.00	11.20	16.89	24.15	32.13	14.35				
RZE10D	-	0.354	0.480	0.704	0.990	1.304	0.604	9.00	12.20	17.89	25.15	33.13	15.35				
RZE11D	-	0.394	0.520	0.744	1.030	1.344	0.644	10.00	13.20	18.89	26.15	34.13	16.35				
RZE12D	-	0.433	0.559	0.783	1.069	1.383	0.683	11.00	14.20	19.89	27.15	35.13	17.35				
RZE13D	-	0.472	0.598	0.822	1.108	1.422	0.722	12.00	15.20	20.89	28.15	36.13	18.35				
RZE14D	-	0.512	0.638	0.862	1.148	1.462	0.762	13.00	16.20	21.89	29.15	37.13	19.35				
RZE15D	-	0.551	0.677	0.901	1.187	1.501	0.801	14.00	17.20	22.89	30.15	38.13	20.35				
RZE16D	-	0.591	0.717	0.941	1.227	1.541	0.841	15.00	18.20	23.89	31.15	39.13	21.35				
RZE17D	-	0.630	0.756	0.980	1.266	1.580	0.880	16.00	19.20	24.89	32.15	40.13	22.35				
RZE18D	-	0.669	0.795	1.019	1.305	1.619	0.919	17.00	20.20	25.89	33.15	41.13	23.35				
RZE19D	-	0.709	0.835	1.059	1.345	1.659	0.959	18.00	21.20	26.89	34.15	42.13	24.35				
RZE20D	-	0.748	0.874	1.098	1.384	1.698	0.998	19.00	22.20	27.89	35.15	43.13	25.35				
RZE21D	-	0.787	0.913	1.137	1.423	1.737	1.037	20.00	23.20	28.89	36.15	44.13	26.35				
RZE22D	-	0.827	0.953	1.177	1.463	1.777	1.077	21.00	24.20	29.89	37.15	45.13	27.35				
RZE23D	-	0.866	0.992	1.216	1.502	1.816	1.116	22.00	25.20	30.89	38.15	46.13	28.35				
RZE24D	-	0.906	1.032	1.256	1.542	1.856	1.156	23.00	26.20	31.89	39.15	47.13	29.35				
RZE25D	-	0.945	1.071	1.295	1.581	1.895	1.195	24.00	27.20	32.89	40.15	48.13	30.35				
RZE26D	-	0.984	1.110	1.334	1.620	1.934	1.234	25.00	28.20	33.89	41.15	49.13	31.35				
RZE27D	-	1.024	1.150	1.374	1.660	1.974	1.274	26.00	29.20	34.89	42.15	50.13	32.35				
RZE28D	-	1.063	1.189	1.413	1.699	2.013	1.313	27.00	30.20	35.89	43.15	51.13	33.35				
RZE29D	-	1.102	1.228	1.452	1.738	2.052	1.352	28.00	31.20	36.89	44.15	52.13	34.35				
RZE30D	-	1.142	1.268	1.492	1.778	2.092	1.392	29.00	32.20	37.89	45.15	53.13	35.35				
RZE31D	-	1.181	1.307	1.531	1.817	2.131	1.431	30.00	33.20	38.89	46.15	54.13	36.35				
RZE32D	-	1.220	1.346	1.570	1.856	2.170	1.470	31.00	34.20	39.89	47.15	55.13	37.35				
RZE33D	-	1.260	1.386	1.610	1.896	2.210	1.510	32.00	35.20	40.89	48.15	56.13	38.35				
RZE34D	-	1.299	1.425	1.649	1.935	2.249	1.549	33.00	36.20	41.89	49.15	57.13	39.35				
RZE35D	-	1.339	1.465	1.689	1.975	2.289	1.589	34.00	37.20	42.89	50.15	58.13	40.35				
RZE36D	-	1.378	1.504	1.728	2.014	2.328	1.628	35.00	38.20	43.89	51.15	59.13	41.35				
RZE37D	-	1.417	1.543	1.767	2.053	2.367	1.667	36.00	39.20	44.89	52.15	60.13	42.35				
RZE38D	-	1.457	1.583	1.807	2.093	2.407	1.707	37.00	40.20	45.89	53.15	61.13	43.35				
RZE39D	-	1.496	1.622	1.846	2.132	2.446	1.746	38.00	41.20	46.89	54.15	62.13	44.35				
RZE40D	-	1.535	1.661	1.885	2.171	2.485	1.785	39.00	42.20	47.89	55.15	63.13	45.35				
RZE41D	-	1.575	1.701	1.925	2.211	2.525	1.825	40.00	43.20	48.89	56.15	64.13	46.35				
RZE42D	-	1.614	1.740	1.964	2.250	2.564	1.864	41.00	44.20	49.89	57.15	65.13	47.35				
RZE43D	-	1.654	1.780	2.004	2.290	2.604	1.904	42.00	45.20	50.89	58.15	66.13	48.35				
RZE44D	-	1.693	1.819	2.043	2.329	2.643	1.943	43.00	46.20	51.89	59.15	67.13	49.35				
RZE45D	-	1.732	1.858	2.082	2.368	2.682	1.982	44.00	47.20	52.89	60.15	68.13	50.35				
RZE46D	-	1.772	1.898	2.122	2.408	2.722	2.022	45.00	48.20	53.89	61.15	69.13	51.35				
RZE47D	-	1.811	1.937	2.161	2.447	2.761	2.061	46.00	49.20	54.89	62.15	70.13	52.35				
RZE48D	-	1.850	1.976	2.200	2.486	2.800	2.100	47.00	50.20	55.89	63.15	71.13	53.35				
RZE49D	-	1.890	2.016	2.240	2.526	2.840	2.140	48.00	51.20	56.89	64.15	72.13	54.35				
RZE50D	-	1.929	2.055	2.279	2.565	2.879	2.179	49.00	52.20	57.89	65.15	73.13	55.35				

* Contact Factory for Other Positions