

阅读申明

- 1.本站收集的数据手册和产品资料都来自互联网，版权归原作者所有。如读者和版权方有任何异议请及时告之，我们将妥善解决。
- 2.本站提供的中文数据手册是英文数据手册的中文翻译，其目的是协助用户阅读，该译文无法自动跟随原稿更新，同时也可能存在翻译上的不当。建议读者以英文原稿为参考以便获得更精准的信息。
- 3.本站提供的产品资料，来自厂商的技术支持或者使用者的心得体会等，其内容可能存在描述上的差异，建议读者做出适当判断。
- 4.如需与我们联系，请发邮件到marketing@iczoom.com，主题请标有“数据手册”字样。

Read Statement

1. The datasheets and other product information on the site are all from network reference or other public materials, and the copyright belongs to the original author and original published source. If readers and copyright owners have any objections, please contact us and we will deal with it in a timely manner.
2. The Chinese datasheets provided on the website is a Chinese translation of the English datasheets. Its purpose is for reader's learning exchange only and do not involve commercial purposes. The translation cannot be automatically updated with the original manuscript, and there may also be improper translations. Readers are advised to use the English manuscript as a reference for more accurate information.
3. All product information provided on the website refer to solutions from manufacturers' technical support or users the contents may have differences in description, and readers are advised to take the original article as the standard.
4. If you have any questions, please contact us at marketing@iczoom.com and mark the subject with "Datasheets" .

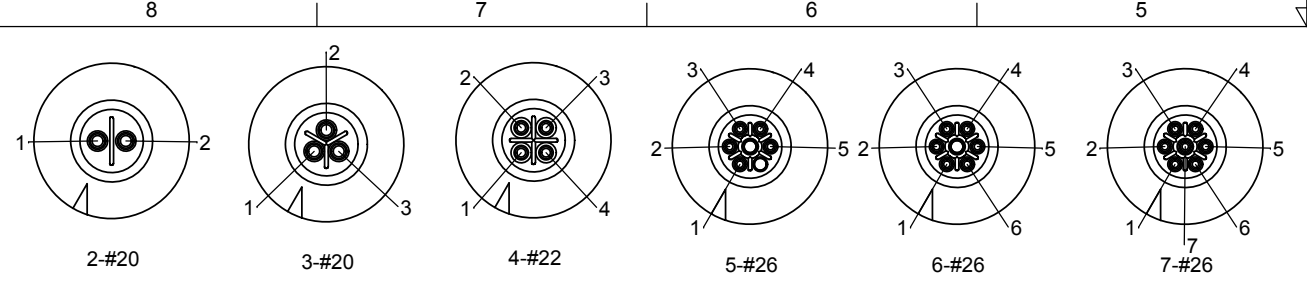

CONTACT ARRANGEMENTS
PANEL CONNECTOR REAR (WIRING SIDE) VIEW

EN2 PANEL CONNECTOR FIELD ASSEMBLY INSTRUCTIONS:

Strip cable end and conductors as shown.

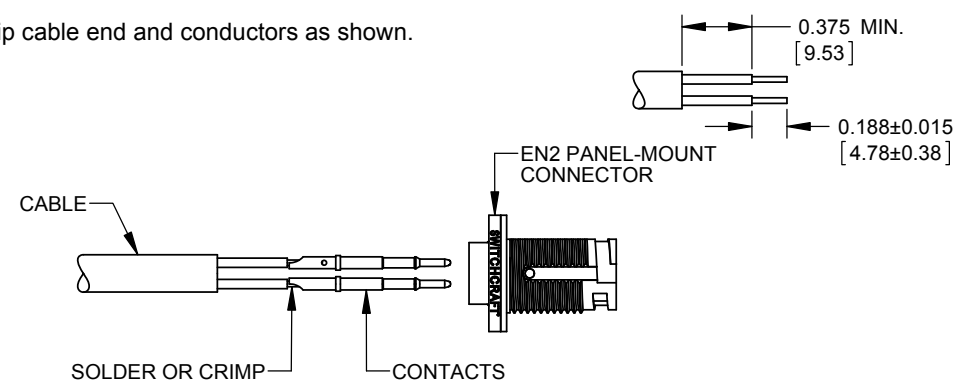

D Soldering or crimping conductors to contacts is recommended before insertion into connector. If crimping, use hand or pneumatic crimp tool with crimp positioner per contact size. If soldering after contacts are inserted in the connector, limit exposure of contacts to soldering iron temperature to 4 sec. maximum. Soldering iron temperature should not exceed 650°F (343°C).

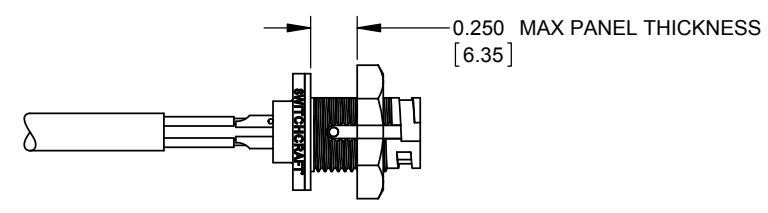

Insert wired contacts into connector housing using an insertion tool and per contacts arrangements. Align and install connector into panel cut-out. Tighten hex nut 5-6 in-lb.

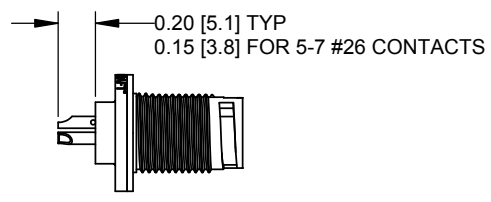

SOLDER OR CRIMP TYPE CONTACTS

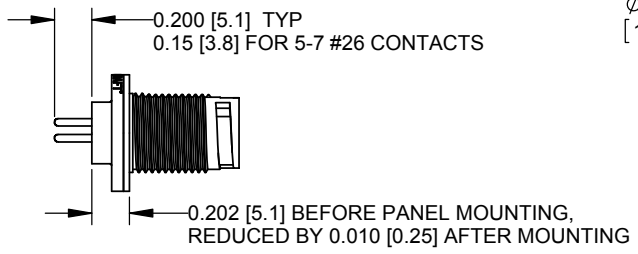

PC TAIL TYPE CONTACTS

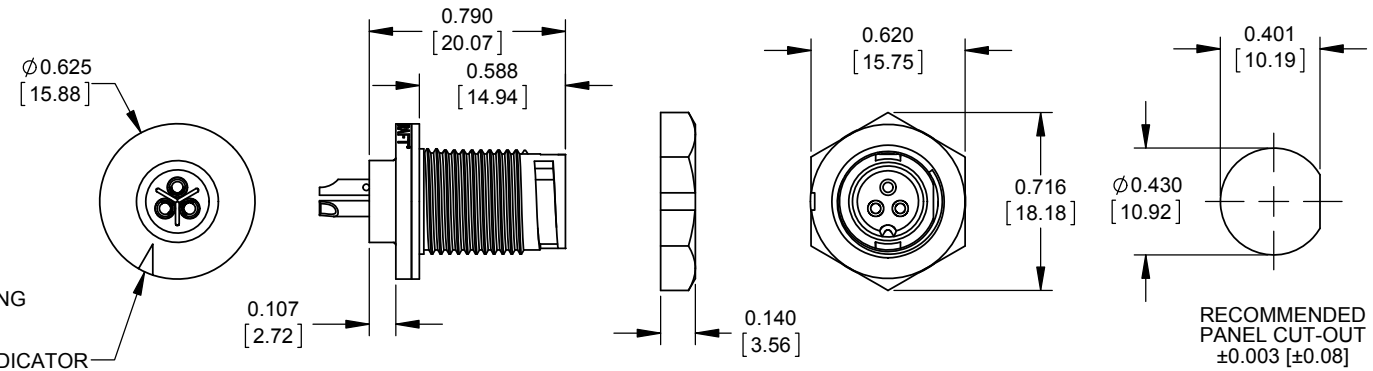

PIN 1 INDICATOR

RECOMMENDED PANEL CUT-OUT ±0.003 [±0.08]

ALL DIMENSIONS FOR REFERENCE ONLY

CUSTOMER DRAWING

PART NUMBER SCHEME:

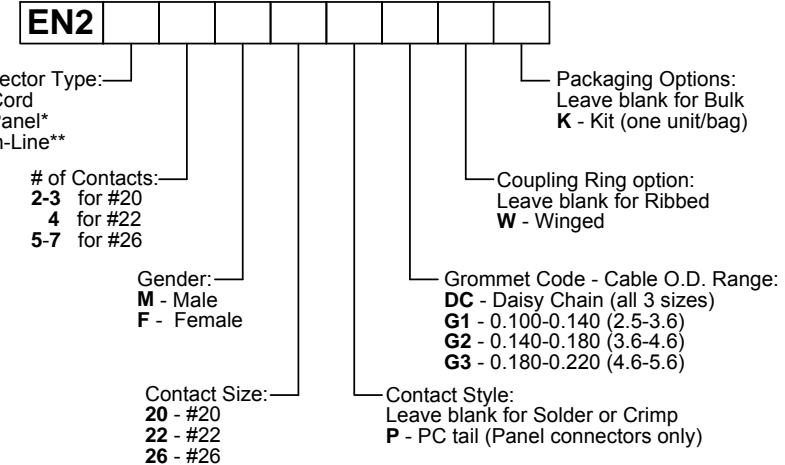

* for mating Cord connectors refer to EN2C SERIES drawing.
** Mating In-Line connectors not currently available.

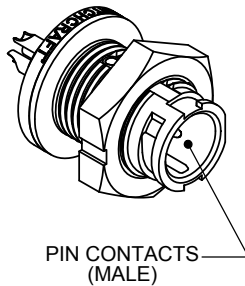

PIN CONTACTS (MALE)

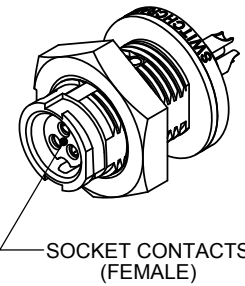

SOCKET CONTACTS (FEMALE)

SPECIFICATIONS:

MECHANICAL
Life: 600 cycles minimum
Vibration: Mil-Std 202G Method 201A
Hex Nut Tongue: 5-6 in-lb

ELECTRICAL
Voltage Rating: 250 V AC/DC for 2 contact arrangement
125 V AC/DC for 3-7 contact arrangements
Insulation Resistance: 1000 mΩ minimum
Contact Resistance: 10 mΩ maximum
Current Rating: Refer to Current Rating Table

ENVIRONMENTAL
Operating Temperature Limits: -40°C to +85°C (-40°F to +185°F), see Current Rating Table.
Moisture Resistance: Mil-Std 202G Method 106G
Insulation Resistance: Mil-Std 202G Method 302
Thermal Shock: Mil-Std 202G Method 107G
Salt Atmosphere (Corrosion): Mil-Std 202G Method 101E
Wear/tight Ratings: IP16, IP18, IP66, IP67, IP68 per IEC60529
NEMA 250 (6P), CFR 46 Part 110.20

MATERIAL
Connector Housing ----- Thermoplastic, black
Hex Nut: ----- Thermoplastic, black
Coupling Ring ----- Thermoplastic, black
Cable Clamp ----- Thermoplastic, black
Handle (back-shell) ----- Thermoplastic, black
Insulator ----- Elastomer, black
Seal Grommet ----- Elastomer, black
Contacts ----- Copper Alloy, plated

Contacts	Wire (awg)	Current Rating (A) at Operating Temperature (°C)				
		45°C max.	55°C max.	65°C max.	75°C max.	85°C max.
2 #20	20	7	6	5	4	3.5
	22	5.5	5	4	3	2.5
	24	5.5	5	4	3	2.5
	26	4	3.5	2.5	2	1
3 #20	20	6.5	5.5	4.5	3.5	2
	22	5	4.5	3.5	3	1.5
	24	5	4.5	3.5	3	1.5
	26	3	2.5	2	1.5	0.5
4 #22	20	5	4.5	3.5	3	1.5
	22	4.5	4	3	2	1
	24	4.5	4	3	2	1
	26	3	2.5	2	1.5	0.5
5-7 #26	26	3	2.5	2	1.5	1
	28	2.5	2	1.5	1	0.5
	30	2	1.5	1	0.5	0.5

TOOL	TOOL TYPE	POSITIONER	CONTACT SIZE	WIRE SIZES
EN3CR	HAND CRIMP TOOL	EN2POS20	20 and 22	20 and 22 AWG
		EN3POS26	26	26, 28, and 30 AWG
EN3CRAUTO	PNEUMATIC CRIMP TOOL	EN2POS20	20 and 22	20 and 22 AWG
		EN3POS26	26	26, 28, and 30 AWG
EN2CRL	HAND CRIMP TOOL LARGE FRAME	EN2POS20L	20 and 22	20, 22, 24, and 26 AWG
EN2CRAUTOL	PNEUMATIC CRIMP TOOL LARGE FRAME			
EN3INS20	CONTACT	--	20 and 22	--
EN3INS26	INSERTION/EXTRACTION	--	26	--

REV	ECO NUMBER	DATE	BY	APVD
0D	SPECS UPDATED	10/03/13	PNK	SRC
0C	SPECS UPDATED	09/20/12	PNK	SRC
0B	TOOLS REVISED	05/14/12	PNK	*
0A	PRELIMINARY	02/09/12	PNK	*
REVISIONS				

SIZE	WIDTH	MULT	LBS/M	TEMPER
UNLESS OTHERWISE SPECIFIED				
1. ALL DIMENSIONS IN INCHES				
- TWO PLACE DECIMALS ±0.02				
- THREE PLACE DECIMALS ±0.005				
FINISH	SCALE		MATERIAL	
SPEC No.	1.5:1		SPEC No.	
FIRST USED ON				
DATE DRAWN	BY	CHKD	APVD	Switchcraft®
02/09/12	PNK	PNK	SRC	
NAME				SHEET 1 OF 2
EN2P SERIES CONNECTORS, RoHS				REV 0D

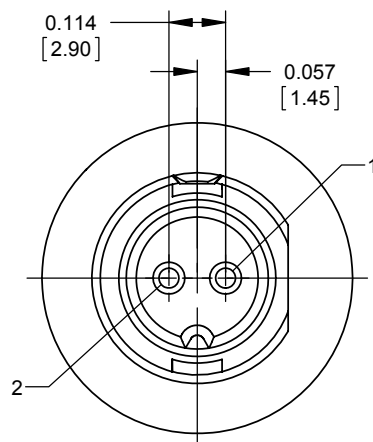

2-#20

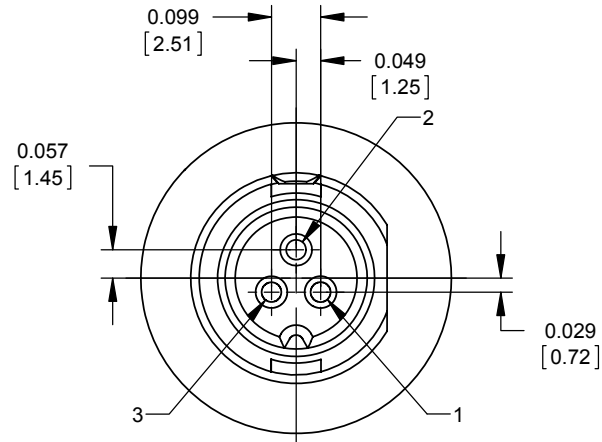

3-#20

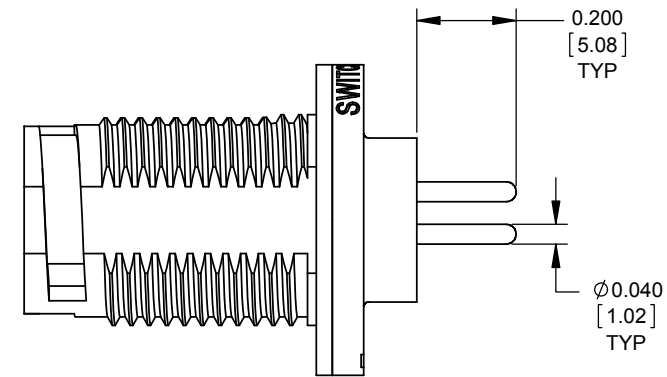

**2 and 3-#20
PIN ARRANGEMENTS
(0.046 [1.17] RECOMMENDED PCB HOLE SIZE)**

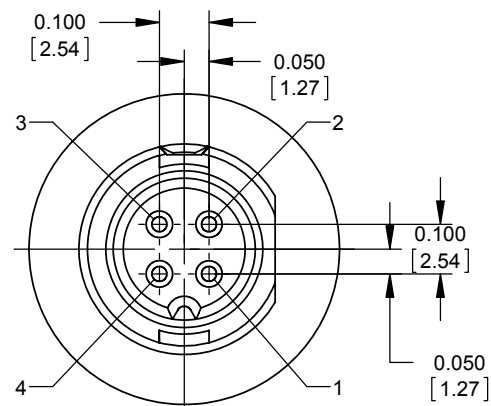

4-#22

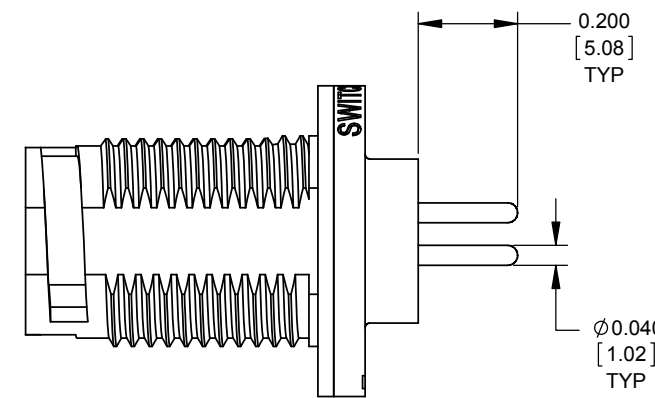

**4-#22
PIN ARRANGEMENT
(0.046 [1.17] RECOMMENDED PCB HOLE SIZE)**

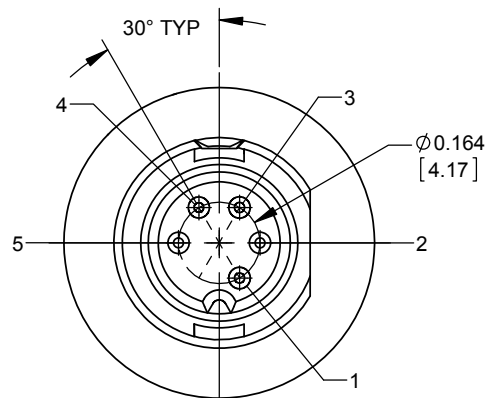

5-#26

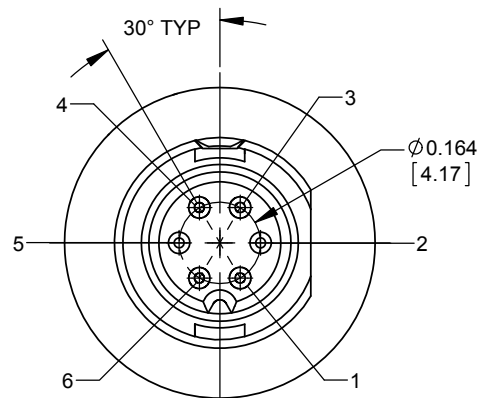

6-#26

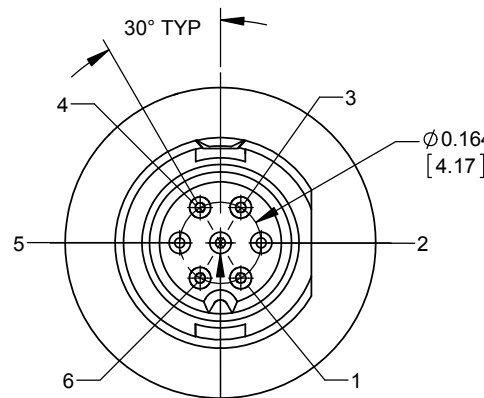

7-#26

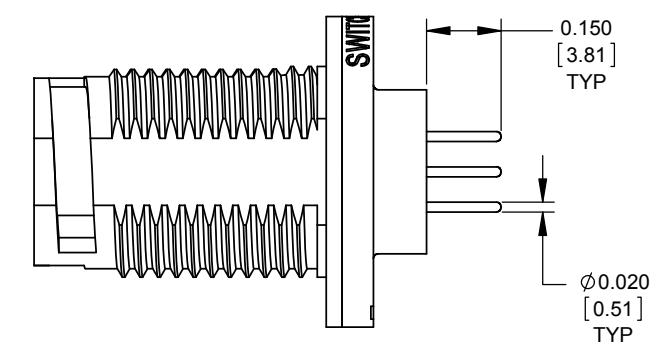

**5, 6, and 7-#26
PIN ARRANGEMENTS
(0.026 [0.66] RECOMMENDED PCB HOLE SIZE)**

**CONTACT ARRANGEMENTS
PANEL CONNECTOR FRONT VIEW (PCB COMPONENT SIDE)
(RECOMMENDED PCB HOLE LAYOUT WITHIN ±0.001 [0.025])**

CUSTOMER DRAWING

UNLESS OTHERWISE SPECIFIED					THIS DRAWING DESCRIBES A DESIGN CONSIDERED PROPRIETARY IN NATURE, DEVELOPED AND MANUFACTURED BY SWITCHCRAFT INC. AND IS RELEASED ON A CONFIDENTIAL BASIS FOR IDENTIFICATION PURPOSES ONLY.				
1. ALL DIMENSIONS IN INCHES - TWO PLACE DECIMALS ±0.02 - THREE PLACE DECIMALS ±0.005					SIZE	WIDTH	MULT	LBS/M	TEMPER
REV					FINISH			MATERIAL	
ECO NUMBER					SPEC No.			SPEC No.	
DATE					FIRST USED ON			SCALE	
BY					DATE DRAWN			1.5:1	
APVD					BY			APVD	
REVISIONS					CHKD			SHEET 2 OF 2	
DO NOT SCALE DRAWING					DATE			PART No.	
SolidWorks CAD File					EN2P SERIES CONNECTORS, RoHS			EN2P SERIES	
					REV			0D	