

## 阅读申明

- 1.本站收集的数据手册和产品资料都来自互联网，版权归原作者所有。如读者和版权方有任何异议请及时告之，我们将妥善解决。
- 2.本站提供的中文数据手册是英文数据手册的中文翻译，其目的是协助用户阅读，该译文无法自动跟随原稿更新，同时也可能存在翻译上的不当。建议读者以英文原稿为参考以便获得更精准的信息。
- 3.本站提供的产品资料，来自厂商的技术支持或者使用者的心得体会等，其内容可能存在描述上的差异，建议读者做出适当判断。
- 4.如需与我们联系，请发邮件到marketing@iczoom.com，主题请标有“数据手册”字样。

## Read Statement

1. The datasheets and other product information on the site are all from network reference or other public materials, and the copyright belongs to the original author and original published source. If readers and copyright owners have any objections, please contact us and we will deal with it in a timely manner.
2. The Chinese datasheets provided on the website is a Chinese translation of the English datasheets. Its purpose is for reader's learning exchange only and do not involve commercial purposes. The translation cannot be automatically updated with the original manuscript, and there may also be improper translations. Readers are advised to use the English manuscript as a reference for more accurate information.
3. All product information provided on the website refer to solutions from manufacturers' technical support or users the contents may have differences in description, and readers are advised to take the original article as the standard.
4. If you have any questions, please contact us at marketing@iczoom.com and mark the subject with "Datasheets" .

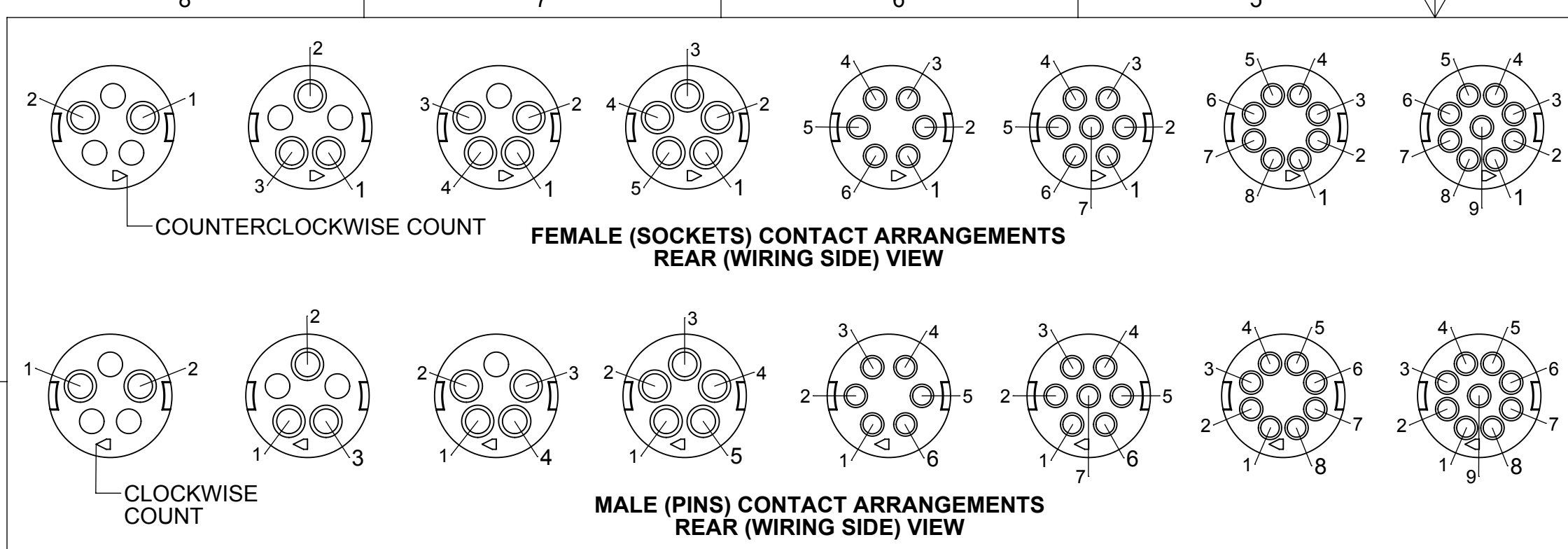

**HS2 P 7 F 20 - K**

Dura-Pull Series

Connector Type:  
**C** - Cable-End  
**P** - Panel, Front-Mount  
**L** - Cable-to-Cable

# of contacts:  
**2-5** for #20  
**6-9** for #26

Gender:  
**M** - Male (Pin)  
**F** - Female (Socket)

Options:  
**K** - Kit Packaging (one unit/bag)  
**[blank]** - Bulk Packaging  
 Consult factory for other options

Contact Size:  
**20** - 20, 22, 24, 26 AWG wires  
**26** - 26, 28, 30 AWG wires

Refer to HS2C SERIES drawing for mating Cable-End connectors.  
 Refer to HS2L SERIES drawing for mating Cable-to-Cable connectors.

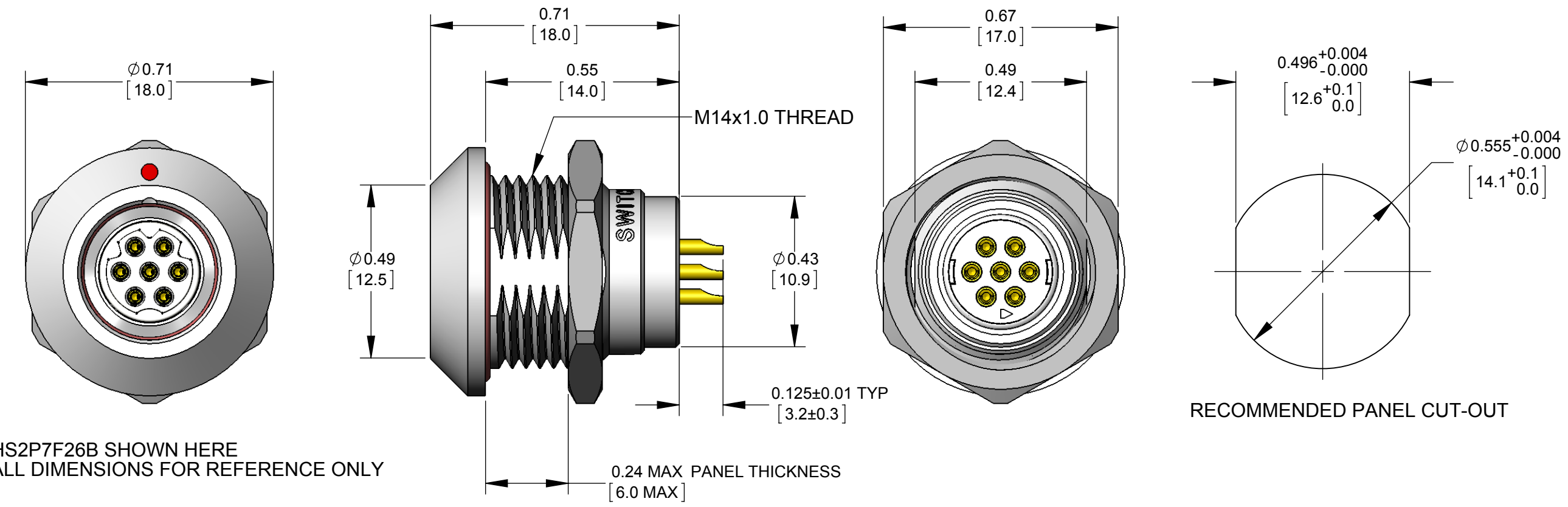
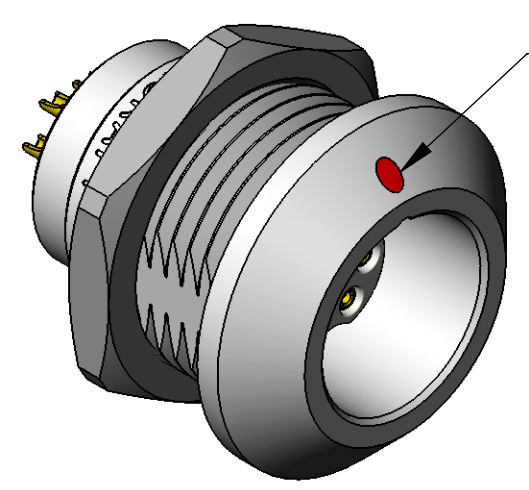

HS2P7F26B SHOWN HERE  
 ALL DIMENSIONS FOR REFERENCE ONLY

| SPECIFICATIONS:                  |   |
|----------------------------------|---|
| <b>MECHANICAL</b>                |   |
| Mating / Locking Type:           | Push-Pull automatic locking/unlocking   |
| Life                             | 5,000 cycles minimum  |
| Operating Forces                 | 10 lb. [44.5 N] maximum Insertion or Withdrawal                                     |
| Vibration                        | Mil-Std 202G Method 201A  |
| Panel-Mount Hex Nut Tongue       | 40 in-lb [4.5 Nm] maximum   |
| Cable Securing System:           | Threaded on metal Clamp   |
| <b>ELECTRICAL</b>                |   |
| Voltage Rating                   | 125 V AC/DC for 2-5 contact arrangements<br>30 V AC/DC for 6-9 contact arrangements |
| Current Rating                   | Refer to Current Carry Capacity Table   |
| Insulation Resistance            | 1000 MΩ minimum   |
| Contact Resistance               | 10 mΩ typical   |
| EMI Shielding                    | 360°  |
| <b>ENVIRONMENTAL</b>             |   |
| Temperature Limits               | -40°C to +135°C (-40°F to +275°F)   |
| Operating Temperature Range      | Refer to Current Carry Capacity Table   |
| Moisture Resistance              | Mil-Std 202G Method 106G  |
| Insulation Resistance            | Mil-Std 202G Method 302   |
| Thermal Shock                    | Mil-Std 202G Method 107G  |
| Salt Atmosphere (Corrosion)      | Mil-Std 202G Method 101E  |
| Ingress Protection Ratings       | IP66, IP67, IP68 (6 ft. for 24 hours) per IEC60529, NEMA 250 6P                     |
| <b>MATERIAL</b>                  |   |
| Outer Shell Metal components     | Copper Alloy, electroless nickel plated   |
| Hex Nut & Inner Metal components | Copper Alloy, nickel plated   |
| Ground Spring Washer             | Stainless Steel   |
| Electrical Insulator             | Medical Technology LCP, natural   |
| Seal O-rings                     | Silicone, red   |
| Contacts                         | Copper Alloy, gold plated   |

| Contacts | Wire (awg) | Current Rating (A) at Operating Temperature (°C) |           |           |            |            | Minimum Test Voltage (V rms) | Voltage (V rms) tested per UL2238 |
|----------|------------|--|-----------|-----------|------------|------------|------------------------------|-----------------------------------|
|          |            | 45°C max.  | 65°C max. | 85°C max. | 100°C max. | 110°C max. |                              |                                   |
| 2 #20    | 20         | 10   | 9         | 8         | 7*         | 6          | 1400                         | 125                               |
|          | 22         | 8.5  | 7.5       | 7.5       | 5.5*       | 4.5        |                              |                                   |
|          | 24         | 7  | 6         | 5         | 4.5*       | 3.5        |                              |                                   |
|          | 26         | 4  | 4         | 3.5       | 3.5*       | 2.5        |                              |                                   |
| 3 #20    | 20         | 9.5  | 8.5       | 7.5       | 6.5*       | 5          |                              |                                   |
|          | 22         | 8  | 7         | 6         | 5*         | 4          |                              |                                   |
|          | 24         | 6  | 5.5       | 4.5       | 4*         | 3          |                              |                                   |
|          | 26         | 3.5  | 3.5       | 3         | 3*         | 2.5        |                              |                                   |
| 4 #20    | 20         | 9  | 8         | 7         | 6*         | 5          |                              |                                   |
|          | 22         | 7.5  | 6.5       | 5.5       | 4.5*       | 3.5        |                              |                                   |
|          | 24         | 5  | 4.5       | 4         | 3.5*       | 2.5        |                              |                                   |
|          | 26         | 3  | 3         | 2.5       | 2.5*       | 2          |                              |                                   |
| 5 #20    | 20         | 8  | 7.5       | 6.5       | 5.5*       | 4.5        |                              |                                   |
|          | 22         | 6.5  | 5.5       | 5         | 4*         | 3          |                              |                                   |
|          | 24         | 4.5  | 4         | 3.5       | 3*         | 2.5        |                              |                                   |
|          | 26         | 2.5  | 2.5       | 2         | 2*         | 1.5        |                              |                                   |
| 6-7 #26  | 26         | 2.5  | 2.5       | 2         | 2*         | 1.5        |                              |                                   |
|          | 28         | 2  | 2         | 1.5       | 1.5*       | 1          |                              |                                   |
|          | 30         | 1.5  | 1.5       | 1         | 1*         | .5         |                              |                                   |
|          | 26         | 2  | 2         | 1.5       | 1.5*       | 1          |                              |                                   |
| 8-9 #26  | 28         | 1.5  | 1.5       | 1         | 1*         | .5         |                              |                                   |
|          | 30         | 1  | 1         | .5        | .5*        | .5         |                              |                                   |

\*Temperature Rise does not exceed 30°C when tested according to UL2238. All other recommended current ratings are based on the Relative Thermal Index of the insulating material.

**PRELIMINARY**

| TOOL       | TOOL TYPE                        | POSITIONER | CONTACT SIZE | WIRE SIZES             |
|------------|----------------------------------|------------|--------------|------------------------|
| EN3CR      | HAND CRIMP TOOL                  | EN2POS20   | 20 and 22    | 20 and 22 AWG          |
| EN3CRAUTO  | PNEUMATIC CRIMP TOOL             | EN3POS26   | 26           | 26, 28, and 30 AWG     |
|            |                                  | EN2POS20   | 20 and 22    | 20 and 22 AWG          |
| EN2CRL     | HAND CRIMP TOOL LARGE FRAME      | EN3POS26   | 26           | 26, 28, and 30 AWG     |
|            |                                  | EN2POS20L  | 20 and 22    | 20, 22, 24, and 26 AWG |
| EN2CRAUTOL | PNEUMATIC CRIMP TOOL LARGE FRAME |            |              |                        |
| EN3INS20   | CONTACT INSERTION                | --         | 20 and 22    | 20, 22, 24, and 26 AWG |
| EN3INS26   | CONTACT INSERTION                | --         | 26           | 26, 28, and 30 AWG     |
| REMT00L20  | CONTACT EXTRACTION               | --         | 20           | 20, 22, 24, and 26 AWG |
| REMT00L26  | CONTACT EXTRACTION               | --         | 26           | 26, 28, and 30 AWG     |

| REV | ECO NUMBER  | DATE     | BY  | APVD |
|-----|-------------|----------|-----|------|
| 0A  | PRELIMINARY | 01/06/16 | PNK | SRC  |

THIS DRAWING DESCRIBES A DESIGN CONSIDERED PROPRIETARY IN NATURE, DEVELOPED AND MANUFACTURED BY SWITCHCRAFT INC. AND IS RELEASED ON A CONFIDENTIAL BASIS FOR IDENTIFICATION PURPOSES ONLY.

UNLESS OTHERWISE SPECIFIED

1. ALL DIMENSIONS IN INCHES [mm]  
 - TWO PLACE DECIMALS ±0.02 [0.5]  
 - THREE PLACE DECIMALS ±0.005 [0.13]

SIZE WIDTH MULT LBS/M TEMPER

FINISH SPEC No. MATERIAL SPEC No.

FIRST USED ON SCALE 3:1

DATE DRAWN BY CHKD APVD  
 01/06/16 PNK 01/06/16 01/06/16

NAME CABLE-END PART No. HS2 SERIES CONNECTOR HS2C SERIES REV 0A

DO NOT SCALE DRAWING

SolidWorks CAD File

**CUSTOMER DRAWING**

# HS2 SERIES PANEL-MOUNT FIELD ASSEMBLY INSTRUCTIONS:

1. STRIP THE CABLE END AND THE CONDUCTORS AS SHOWN HERE.

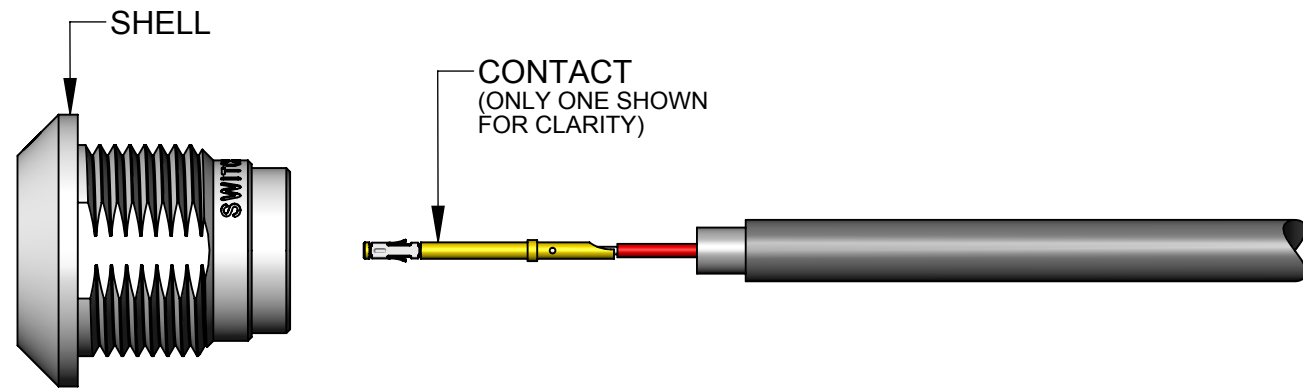
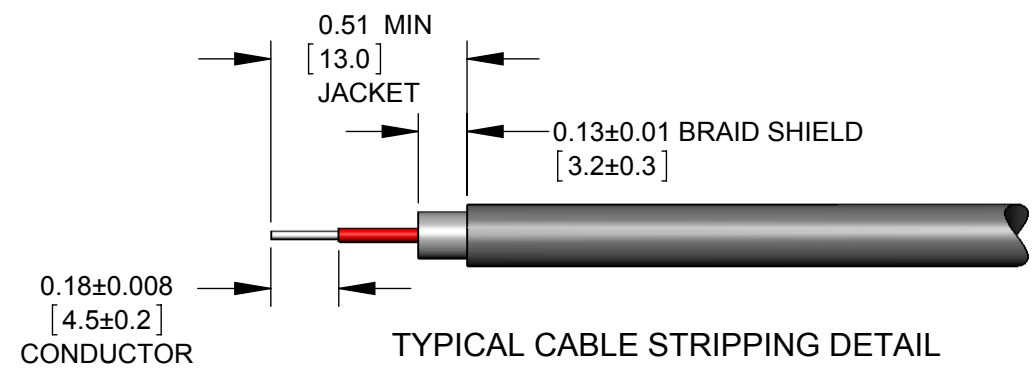

2. CRIMP CONDUCTORS TO CONTACTS USING HAND OR PNEUMATIC CRIMP TOOL\* WITH CRIMP POSITIONER\* SET PER CONTACT SIZE AND WIRE GAGE. IF SOLDERING, IT IS RECOMMENDED TO SOLDER CONDUCTORS TO CONTACTS BEFORE INSERTING THEM INTO INSERT.

3. GUIDE EACH WIRED CONTACT INTO INSERT HOLE AND PUSH UNTIL CONTACT SNAPS IN PLACE. USE INSERTION TOOL\* IF NECESSARY. COLORED CONDUCTORS CAN BE ASSIGNED TO CONTACT POSITION NUMBERS AS DESIRED. TO REMOVE A CONTACT, INSERT THE EXTRACTION TOOL\* FROM THE FRONT OF INSERT AND LIGHTLY PRESS THE SPRING LOADED PLUNGER INWARD TO PUSH THE CONTACT OUT.

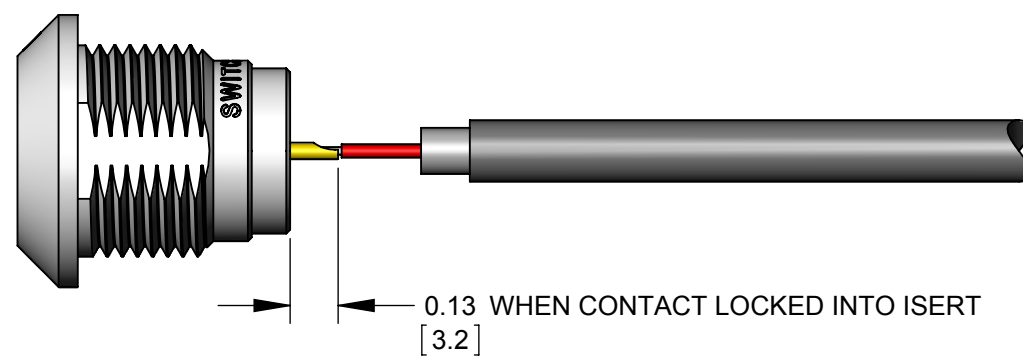

6. ALIGN AND INSTALL FINISHED CONNECTOR INTO PANEL CUT-OUT. TIGHTEN HEX NUT TO A MAXIMUM OF 40 IN-LB [4.5 Nm].

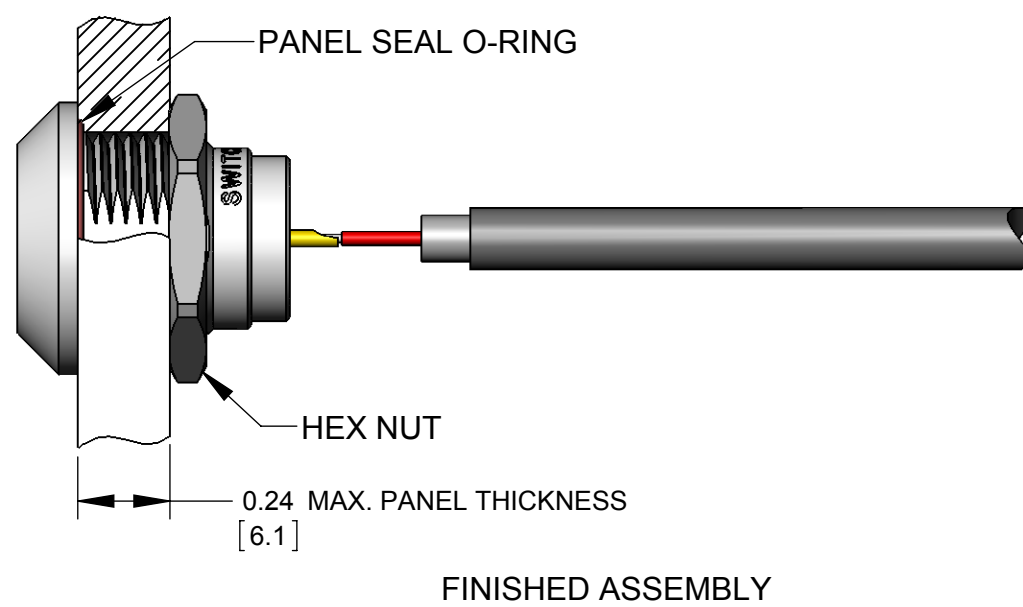

\*REFER TO TOOLS TABLE ON THIS DRAWING FOR SELECTION OF TOOLS PER CONTACT AND WIRE SIZE.

|                        |                            |           |
|------------------------|----------------------------|-----------|
| SCALE<br>2:1           | Switchcraft®               |           |
| DATE DRAWN<br>01/06/16 |                            |           |
| DRAWN BY<br>PNK        | PART No.<br>HS2P SERIES_CD | REV<br>0A |