

阅读申明

- 1.本站收集的数据手册和产品资料都来自互联网，版权归原作者所有。如读者和版权方有任何异议请及时告之，我们将妥善解决。
- 2.本站提供的中文数据手册是英文数据手册的中文翻译，其目的是协助用户阅读，该译文无法自动跟随原稿更新，同时也可能存在翻译上的不当。建议读者以英文原稿为参考以便获得更精准的信息。
- 3.本站提供的产品资料，来自厂商的技术支持或者使用者的心得体会等，其内容可能存在描述上的差异，建议读者做出适当判断。
- 4.如需与我们联系，请发邮件到marketing@iczoom.com，主题请标有“数据手册”字样。

Read Statement

1. The datasheets and other product information on the site are all from network reference or other public materials, and the copyright belongs to the original author and original published source. If readers and copyright owners have any objections, please contact us and we will deal with it in a timely manner.
2. The Chinese datasheets provided on the website is a Chinese translation of the English datasheets. Its purpose is for reader's learning exchange only and do not involve commercial purposes. The translation cannot be automatically updated with the original manuscript, and there may also be improper translations. Readers are advised to use the English manuscript as a reference for more accurate information.
3. All product information provided on the website refer to solutions from manufacturers' technical support or users the contents may have differences in description, and readers are advised to take the original article as the standard.
4. If you have any questions, please contact us at marketing@iczoom.com and mark the subject with "Datasheets" .

Circular Light Module (CN88)

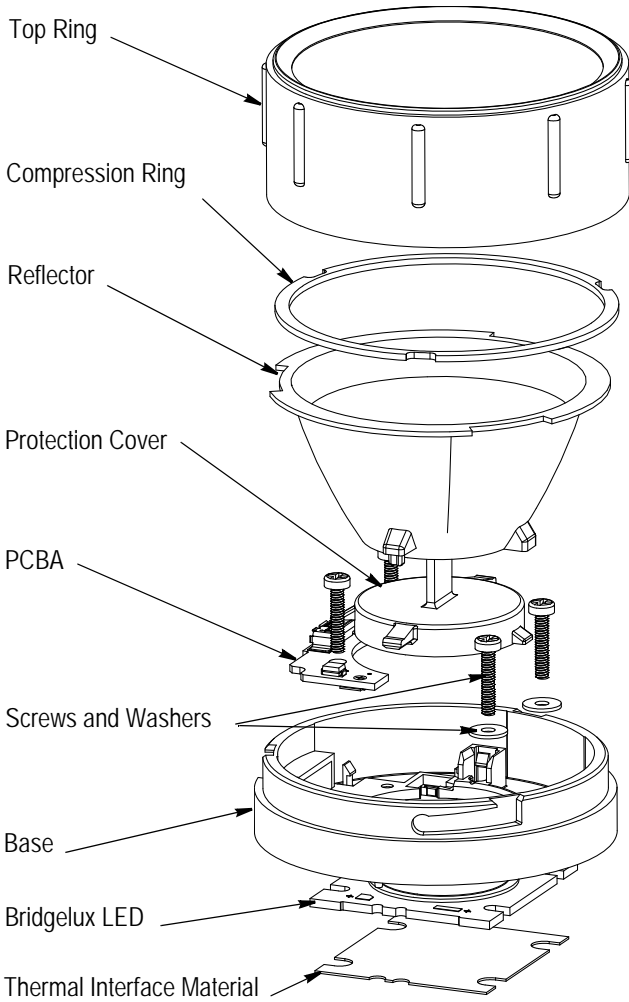

Figure 1

1. INTRODUCTION

The circular Light Module (CN88), (part number 2154159-[]), is designed as a compact, self-contained, easy-to-mount, plug-and-play circular module to be used in both prototype and custom production applications. This module is to be used with the NEVALO* Interconnect System (refer to Tyco Electronics (TE) Application Specification 114-13290). The module can be used with the Straight and Right-Angle NEVALO Connectors.



All numerical are in metric units [with U.S. customary units in brackets]. Dimensions are in millimeters. Unless otherwise specified, dimensions have a tolerance of ± 0.13 and angles have a tolerance of $\pm 2^\circ$. Figures and illustrations are for identification only and not drawn to scale.

Bridgelux is a trademark.

2. DESCRIPTION

This module consists of a base with mounting hardware, Bridgelux LED, PCBA with thermal protection, Thermal Interface Material (TIM), protection cover, reflector with multiple beam angle configurations (narrow and wide), and a snap-on top ring. The module is available in several configurations. See Figure 1.

3. ASSEMBLY PROCEDURE

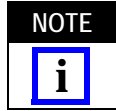

The module must be assembled by a qualified electrician in accordance with national and local electrical codes and the following instructions.

3.1. Heat Sink Mounting

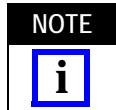

The thermal management of the overall system is critical to the life of the LED. It is very important that the thermal management is adequate for the LED lighting fixture being used. For more detailed information, refer to Application Specification 114-13300.

Figure 2 shows a properly sized heat sink mounting pattern. For low volume production applications of the CN88, TE offers a Transfer Punch Guide (part number 2154454-1) to assist in the making of the heat sink mounting hole drill locations. See Figure 2.

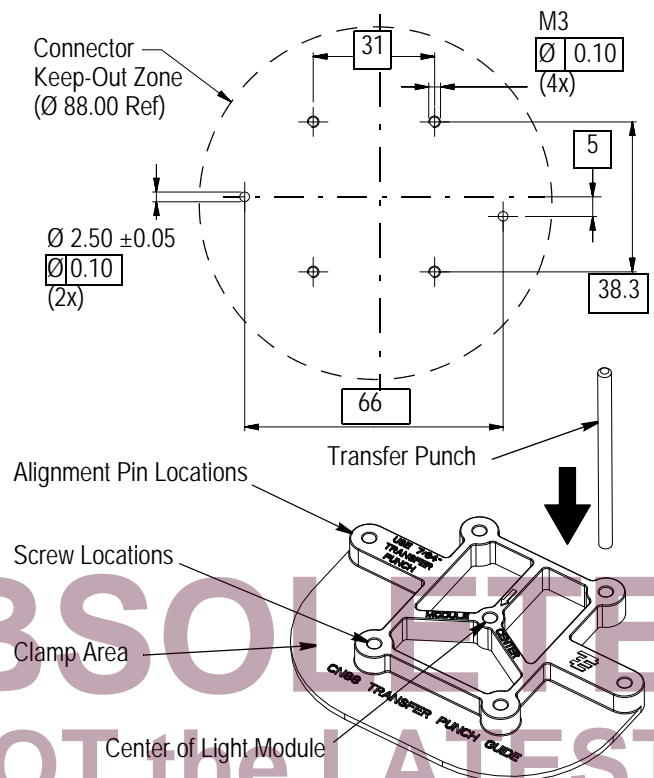

Figure 2

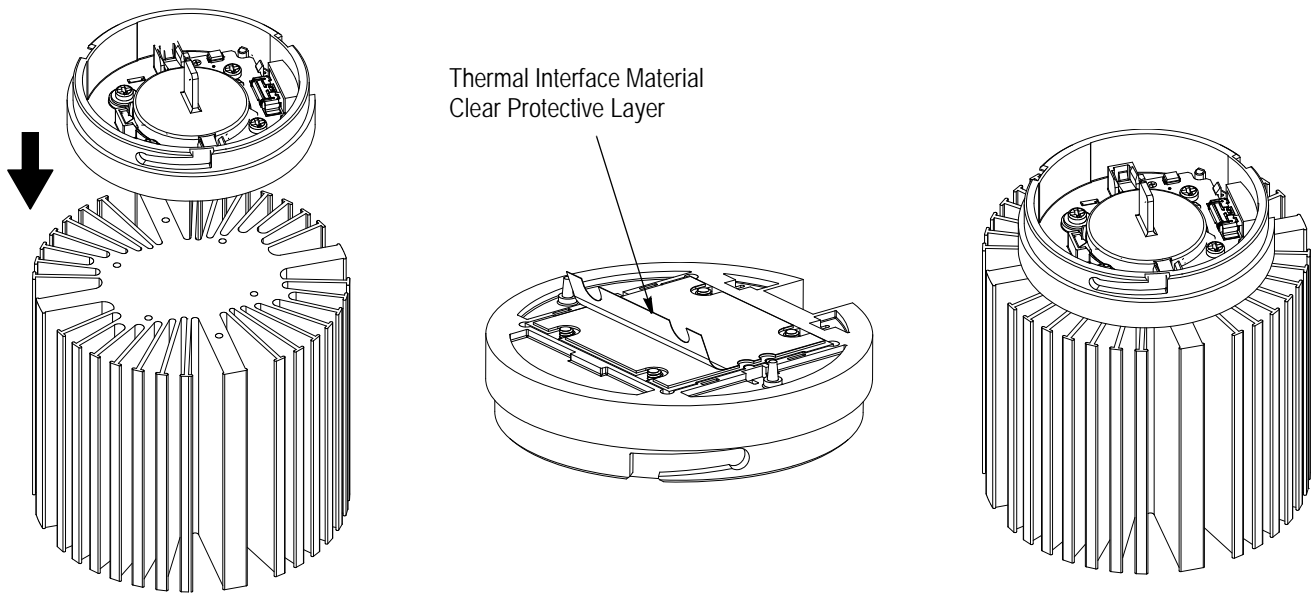

Figure 3

3.2. Mounting the Circular Light Module (CN88)

1. Once the heat sink has been properly sized and prepared for the application of the Circular Light Module (CN88), the base sub-assembly (base housing, screws, protection cover, PCBA, LED, and TIM) can be aligned over the mounting holes. Mounting screws to be alternately tightened to a torque of 0.28 to 0.45 N•m [2.5 to 4.0 in.-lbf]. See Figure 3. The protective cover can now be removed.



When mounting the module, care must be taken not to damage the light module and LEDs with the screwdriver used for tightening the mounting screws. The protection cover is protecting the LED during this operation.



If the clear protective layer on the TIM material is not removed, optimum thermal performance will not be achieved.

2. The reflector is then installed, aligning three keyways. Reflector posts have a slight click-fit into the light engine holes. Firmly seat the optic in place. See Figure 4.



TE recommends that when handling the reflector, that non-marking gloves be used. The reflector should be handled by the outer diameter to eliminate the chance of leaving marks within the light emitting area.

3. The top ring (with compression ring pre-assembled) is then lowered over the light module, aligning three (3) pegs in the top ring to three (3) guide features in the base. With a slight downward pressure (to compress the compression ring and a clockwise twist), you will feel and hear a tactile and audible click. This secures the top ring on the Circular Light Module (CN88) and completes the assembly. See Figure 5. Refer to Application

Specification 114-13290 for information on assembly procedures on the NEVALO Interconnect System.

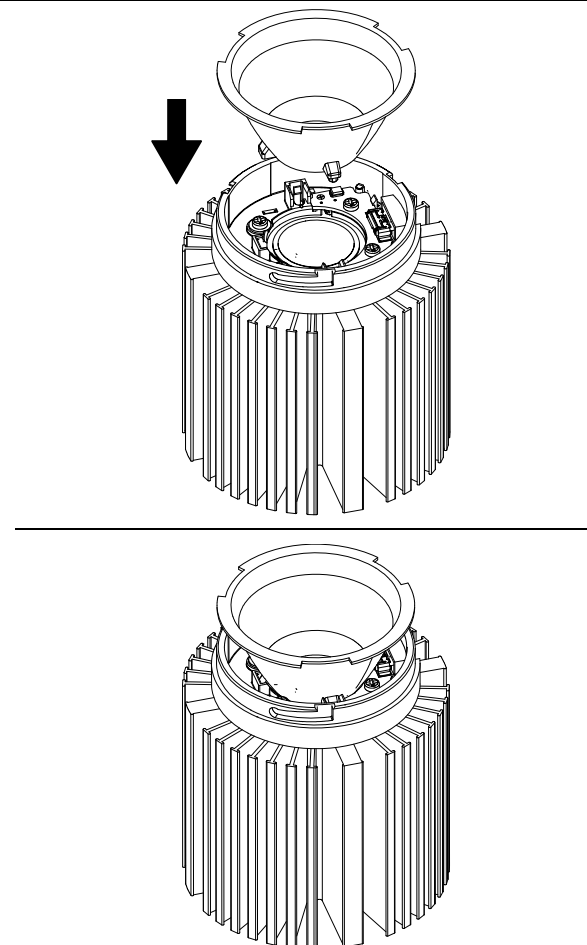

Figure 4

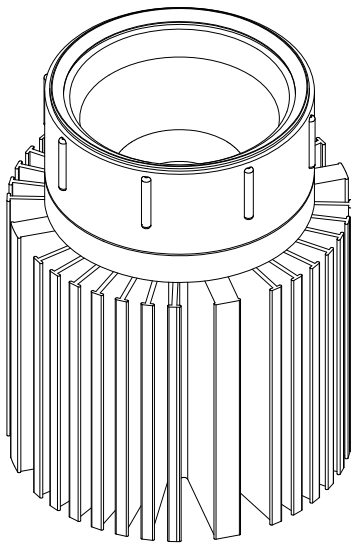
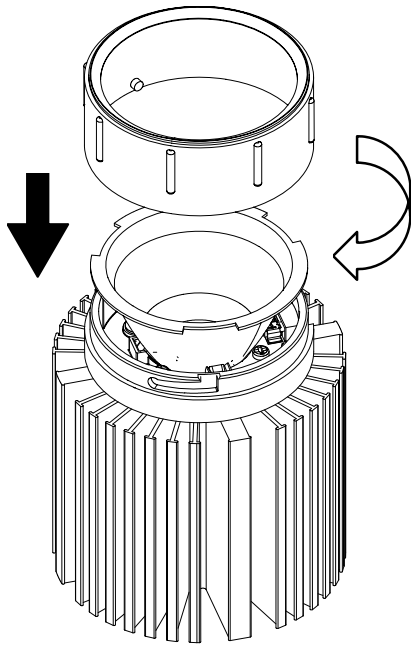

Figure 5

4. After the Circular Light Module (CN88) is secured to the heat sink, the mating NEVALO Cable Assembly can be mated to energize the module. The Circular Light Module (CN88) will accept the Straight and Right-Angle NEVALO Connectors. Straight is shown in Figure 6.

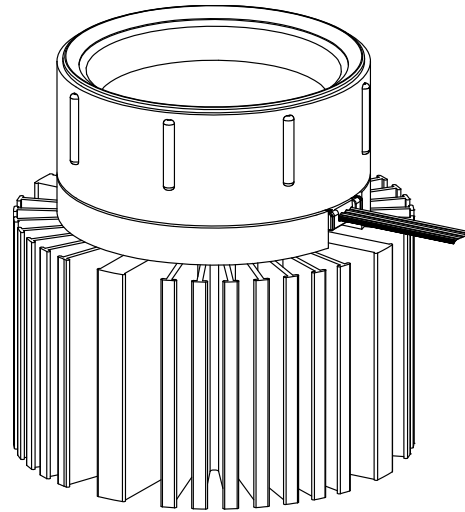

Figure 6

4. REPLACEMENT AND REPAIR



Circular Light Module (CN88) components are not repairable. If it is evident that a component is damaged, it must be removed and replaced with a new component.

Order products through your local Tyco Electronics Representative, or call 1-800-526-5142, or send a facsimile of your purchase order to 1-717-986-7605, or write to:

CUSTOMER SERVICE (038-035)
 TYCO ELECTRONICS CORPORATION
 PO BOX 3608
 HARRISBURG PA 17105-3608

5. REVISION SUMMARY

- Initial release of document