

## 阅读申明

- 1.本站收集的数据手册和产品资料都来自互联网，版权归原作者所有。如读者和版权方有任何异议请及时告之，我们将妥善解决。
- 2.本站提供的中文数据手册是英文数据手册的中文翻译，其目的是协助用户阅读，该译文无法自动跟随原稿更新，同时也可能存在翻译上的不当。建议读者以英文原稿为参考以便获得更精准的信息。
- 3.本站提供的产品资料，来自厂商的技术支持或者使用者的心得体会等，其内容可能存在描述上的差异，建议读者做出适当判断。
- 4.如需与我们联系，请发邮件到marketing@iczoom.com，主题请标有“数据手册”字样。

## Read Statement

1. The datasheets and other product information on the site are all from network reference or other public materials, and the copyright belongs to the original author and original published source. If readers and copyright owners have any objections, please contact us and we will deal with it in a timely manner.
2. The Chinese datasheets provided on the website is a Chinese translation of the English datasheets. Its purpose is for reader's learning exchange only and do not involve commercial purposes. The translation cannot be automatically updated with the original manuscript, and there may also be improper translations. Readers are advised to use the English manuscript as a reference for more accurate information.
3. All product information provided on the website refer to solutions from manufacturers' technical support or users the contents may have differences in description, and readers are advised to take the original article as the standard.
4. If you have any questions, please contact us at marketing@iczoom.com and mark the subject with "Datasheets" .

REVISION TABLE					
REV.	ECO #	DESCRIPTION	DATE	BY	APPROVED
24	AC095112	MODIFIED DIMENSIONING SCHEME UPDATED TO SOLIDWORKS	12/16/09	MF	TW

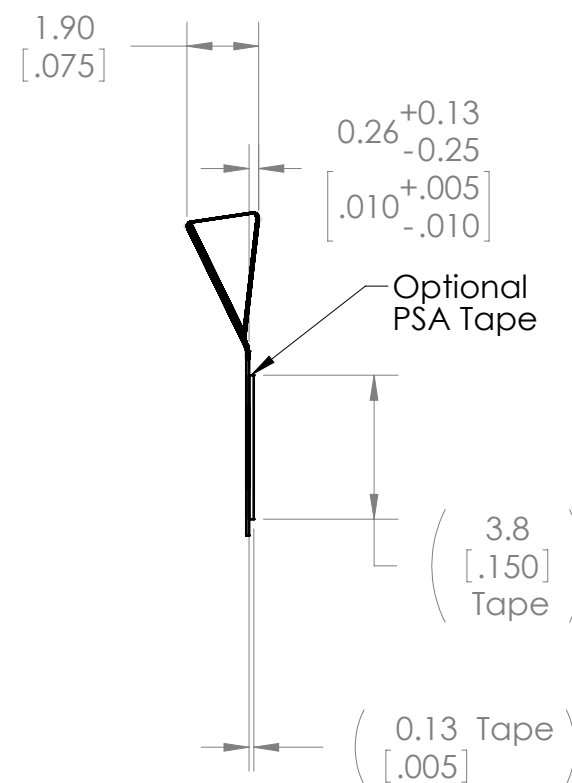
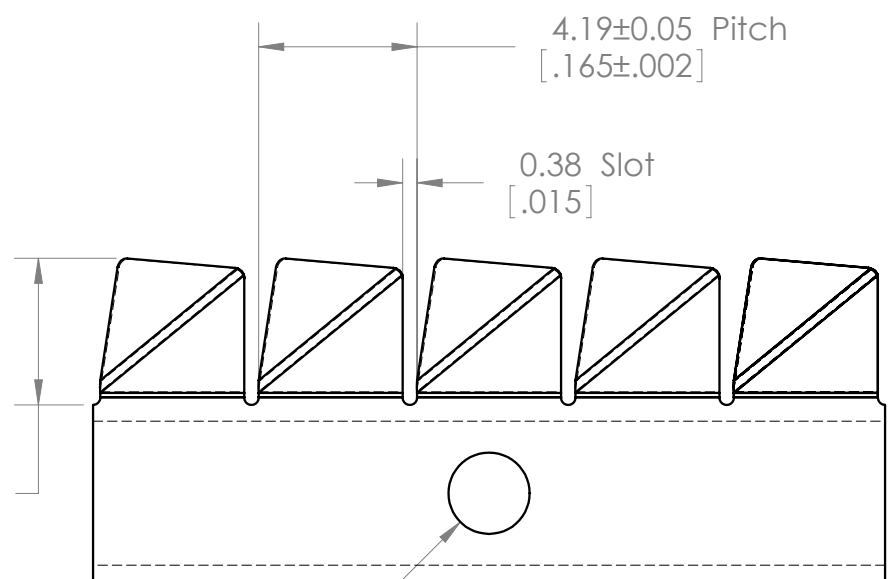
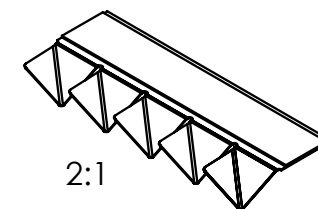
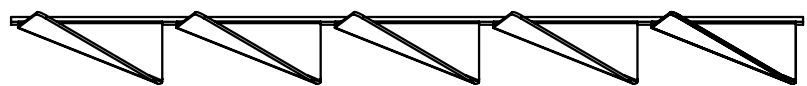

( 3.88  
[.153] )

( Ø2.15  
[.085] )

0.19  
[.008]  
PARTING TAB  
MAY BE PRESENT  
TYP

( 3.8  
[.150]  
Tape )

( 0.13 Tape  
[.005] )

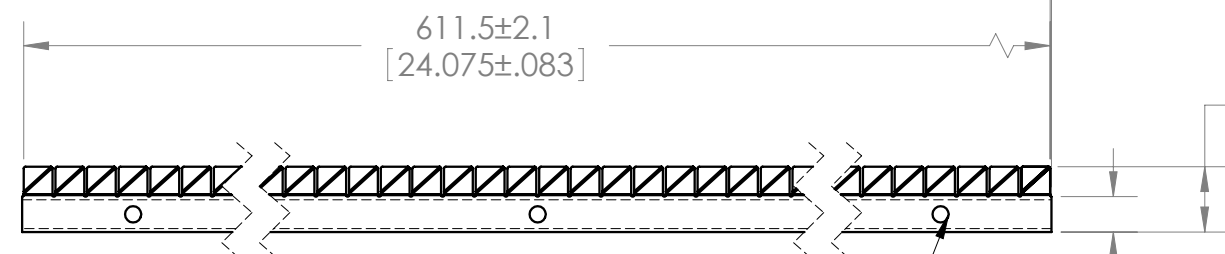

1:1  
FLAT BLANK

Fixturing Holes  
For Finish Requirements  
May Be Present

4.67  
[.184]

**APPROVED**  
By Tim Wrona at 7:22 am, Dec 17, 2009

This 2d drawing is generated from a 3d solid model. Refer to 3d model for any dimensions not shown on this drawing. 3d model dimensions will always take precedent over drawing dimensions.

Block tolerances apply to metric units only. Dual dimensions shown are for reference only and are displayed in 3 places for conversion purposes only.

CAD MAINTAINED  
DRAWING. MANUAL  
CHANGES UNAUTHORIZED

STD PART REFERENCE:  
0077-00xx

UNITS: MM (INCH)

TOLERANCES:  
.X = ± .4  
.XX = ± .2  
.XXX = ± .1

ANGULAR:  
X.X° = ± 3.0°  
X.XX° = ± 1.0°



3RD ANGLE  
PROJECTION  
DESIGNED IN SOLIDWORKS

MATERIAL:  
BECU ALLOY 25 1/2 H

HEAT TREAT:  
DHP 383 MINIMUM  
(500 GRAM LOAD)

FINISH:  
PLATING OPTIONS AS REQUIRED

STD THICKNESS: (0077)  
0.076 ± .005 [.0030]  
ULTRA SOFT THICKNESS: (0078)  
0.051 ± .005 [.0020]

PRODUCTION DRAWING  
CONTROLLED DOCUMENT

ROHS COMPLAINT: (BASE PART)  
YES

PART NUMBER SERIES: STANDARD  
0097-0555  
REV: 24  
DATE: 12/16/2009  
PART NUMBER SERIES: ULTRA SOFT  
0078-0555  
MODEL/DRAWN BY: MF  
APPROVED BY: TW

INFORMATION CONTAINED IN THIS DOCUMENT IS CONFIDENTIAL AND PROPRIETARY TO LAIRD TECHNOLOGIES. IT MAY NOT BE DISCLOSED TO ANYONE WITHOUT WRITTEN AUTHORIZATION FROM LAIRD TECHNOLOGIES

SCALE: 5:1

SHEET 1 OF 1

SIZE  
**B**