

阅读申明

- 1.本站收集的数据手册和产品资料都来自互联网，版权归原作者所有。如读者和版权方有任何异议请及时告之，我们将妥善解决。
- 2.本站提供的中文数据手册是英文数据手册的中文翻译，其目的是协助用户阅读，该译文无法自动跟随原稿更新，同时也可能存在翻译上的不当。建议读者以英文原稿为参考以便获得更精准的信息。
- 3.本站提供的产品资料，来自厂商的技术支持或者使用者的心得体会等，其内容可能存在描述上的差异，建议读者做出适当判断。
- 4.如需与我们联系，请发邮件到marketing@iczoom.com，主题请标有“数据手册”字样。

Read Statement

1. The datasheets and other product information on the site are all from network reference or other public materials, and the copyright belongs to the original author and original published source. If readers and copyright owners have any objections, please contact us and we will deal with it in a timely manner.
2. The Chinese datasheets provided on the website is a Chinese translation of the English datasheets. Its purpose is for reader's learning exchange only and do not involve commercial purposes. The translation cannot be automatically updated with the original manuscript, and there may also be improper translations. Readers are advised to use the English manuscript as a reference for more accurate information.
3. All product information provided on the website refer to solutions from manufacturers' technical support or users the contents may have differences in description, and readers are advised to take the original article as the standard.
4. If you have any questions, please contact us at marketing@iczoom.com and mark the subject with "Datasheets" .

PT. 01:

1. FINISH TO ORDER
2. INSPECT
3. ASSEMBLE

PT. 02:

1. FINISH TO ORDER
2. INSPECT
3. ASSEMBLE

ASSEMBLY:

1. ASSEMBLE
2. ASSEMBLE
3. FINAL INSP.

4. SHIPPING

BIENT ZZIXW

Form C-13-06

.616 WAS .7160
 .508 WAS .5160
 .258 WAS .330
 .355 WAS .500
 WORKING
 POSITION ADDED
 LBS/M WAS
 30.3 21
 K.D. 21
 3-26 85
 O.P.S ADDED
 REF. NAME
 OPER. NO. WAS
 2009185JWS
 K.D. 21
 3-18-85
 3
 DWG NO. WAS
 0097-C-0951
 .0162 WAS
 .018
 MAT'L THICKNESS
 WAS .0042
 P.T. 02 ADDED
 K.D. 21
 4
 10-21-85
 ADDED .4500
 REMOVED DETAIL
 P.T. 02 WAS REC'D.
 P.T. 01 WAS I/L
 WAS 7.00
 K.D. 21
 12-10-85
 5
 P.T. 03 WAS
 8041-D-095A
 K.D. 21
 8-7-86
 6
 14.970 WAS 15.000
 .548 WAS .700 4
 REVISED VIEW
 4
 7
 9-5-86
 1.500 WAS
 4.500
 *NOTE REVISED
 P.T. 03 WAS
 4 LEGID
 K.D. 21
 11-26-86
 8
 97-944 WAS
 97-950-
 CHANGE SHAPE
 OF RIVET
 ECN4118
 805-24-87
 9
 ADD OPTO
 ASSEMBLE
 ECN5123
 805-24-87
 10
 85-3-27-81

DWG. NO. 0097-C-0952

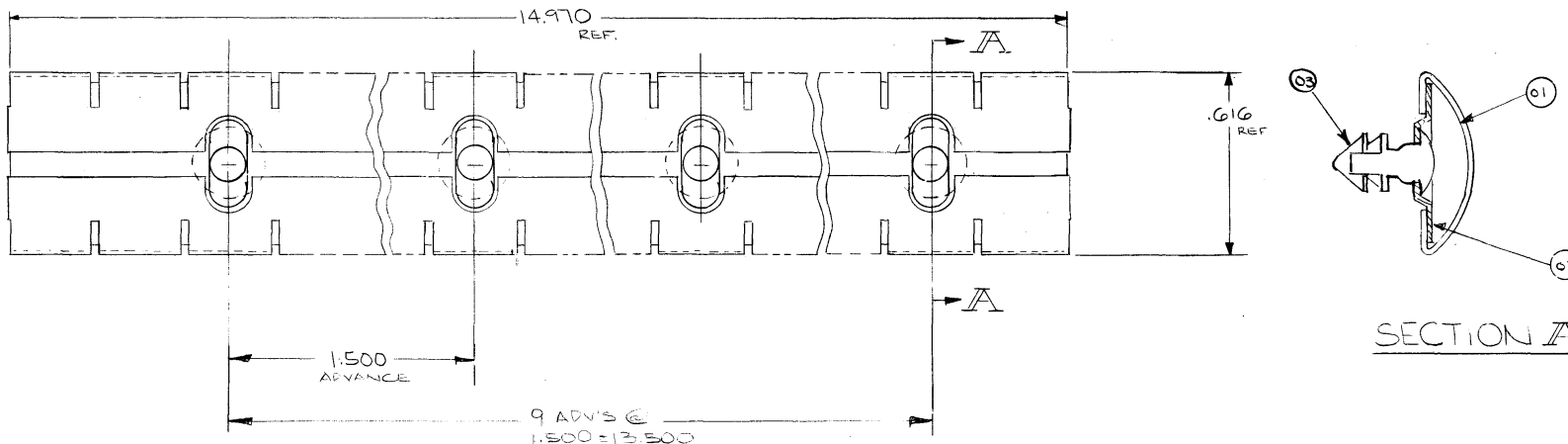

SECTION A-A

	10	03	FASTENER - SEE DWG 0097-D-0944 ①
	1	02	.0162 X .600 BRASS REF. SEE DWG. 0097-C-0932
	1	01	.0038 X 1.320 BE.CU. REF. SEE DWG. 0097-C-0931
REQ'D	ITEM	MATERIAL	
INSTRUMENT SPECIALTIES COMPANY, Inc.			REF. DWG.
DELAWARE WATER GAP, PA			
DRAWN BY	DATE	APPROVED	DATE
CRS	3-21-85	<i>[Signature]</i>	3/21/85
SCALE		SUB	
2:1		10	
DWG. NO.			0097-C-0952

 TOL UNLESS
 OTHERWISE SPEC.
 DEC ± .010
 FRACT. ±
 ANGLES ±

0097-C-0952