

## 阅读申明

- 1.本站收集的数据手册和产品资料都来自互联网，版权归原作者所有。如读者和版权方有任何异议请及时告之，我们将妥善解决。
- 2.本站提供的中文数据手册是英文数据手册的中文翻译，其目的是协助用户阅读，该译文无法自动跟随原稿更新，同时也可能存在翻译上的不当。建议读者以英文原稿为参考以便获得更精准的信息。
- 3.本站提供的产品资料，来自厂商的技术支持或者使用者的心得体会等，其内容可能存在描述上的差异，建议读者做出适当判断。
- 4.如需与我们联系，请发邮件到marketing@iczoom.com，主题请标有“数据手册”字样。

## Read Statement

1. The datasheets and other product information on the site are all from network reference or other public materials, and the copyright belongs to the original author and original published source. If readers and copyright owners have any objections, please contact us and we will deal with it in a timely manner.
2. The Chinese datasheets provided on the website is a Chinese translation of the English datasheets. Its purpose is for reader's learning exchange only and do not involve commercial purposes. The translation cannot be automatically updated with the original manuscript, and there may also be improper translations. Readers are advised to use the English manuscript as a reference for more accurate information.
3. All product information provided on the website refer to solutions from manufacturers' technical support or users the contents may have differences in description, and readers are advised to take the original article as the standard.
4. If you have any questions, please contact us at marketing@iczoom.com and mark the subject with "Datasheets" .

# CLASS CC KLKR SERIES FUSES

600 VAC • 300 VDC • Fast-Acting • 1/10-30 A



## Description

KLKR Series Class CC fuses are fast-acting fuses intended for general purpose branch circuit protection. Their compact size, fast-acting overload response, and highly current-limiting design make them ideal for use in OEM equipment and control panels.

## Features/Benefits

- Meets UL and CSA standards
- Class CC fuses are the smallest 600 V, 200,000 A.I.R. fuses approved for branch circuit protection
- Rejection feature prevents use of fuses with lower interrupting ratings or voltage ratings when used with corresponding fuse holders
- Extremely current limiting reduces damage caused by heating and magnetic effects of short-circuit currents

## Applications

- General purpose protections for equipment requiring fast overload protection

## Specifications

<b>Voltage Rating</b>	AC: 600 V DC: 300 V
<b>Amperage Rating</b>	1/10 – 30 A
<b>Interrupting Rating</b>	AC: 200 kA rms symmetrical DC: 20 kA
<b>Material</b>	Body: Melamine Caps: Nickel-plated Bronze
<b>Fuse Weight</b>	1/10 – 1 A: .030 lb (13.61g) 1 1/2 – 30 A: .034 lb (15.42g)
<b>Approvals</b>	AC: Standard 248-4, Class CC UL Listed 1/10-30 A (File: E81895) CSA Certified 1/10-30 A (File: LR29862) DC: Littelfuse self-certified
<b>Environmental</b>	RoHS Compliant
<b>Country of Origin</b>	Mexico

## Ordering Information

AMPERAGE RATINGS				
1/10	1/2	2 1/2	6	12
1/8	3/4	3	7	15
2/10	1	3 1/2	8	20
1/4	1 1/2	4	9	25
3/10	2	5	10	30

AMPERAGE	PART NUMBER	ORDERING NUMBER
12	KLKR 12	KLKR012.T

## Web Resources

For additional informations, visit:  
[www.littelfuse.com/klkr](http://www.littelfuse.com/klkr)

## Recommended Fuse Holders

L60030C Series  
LPSC Touch-Safe Series

## Dimensions Inches (mm)

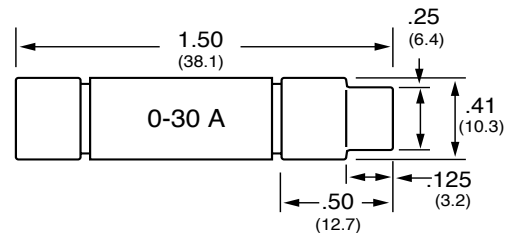

# CLASS CC KLKR SERIES FUSES

## Electrical Specifications

ORDERING NUMBER	AMPERAGE RATING	VOLTAGE RATING		INTERRUPTING RATING		WATTS LOSS AT 100% RATED CURRENT (W)	WATTS LOSS AT 80% RATED CURRENT (W)	TOTAL CLEARING I <sup>2</sup> T (A <sup>2</sup> SEC) 200 kA	AGENCY APPROVALS		RoHS
		AC	DC	AC	DC				UL	VDE	
KLKR001.T	1	600	300	200 kA	20 kA	0.20	0.38	80	•	•	•
KLKR006.T	6	600	300	200 kA	20 kA	0.77	1.36	210	•	•	•
KLKR012.T	12	600	300	200 kA	20 kA	0.83	1.58	6520	•	•	•
KLKR030.T	30	600	300	200 kA	20 kA	2.10	3.75	1720	•	•	•

## Peak Let-Thru Curve

