

## 阅读申明

- 1.本站收集的数据手册和产品资料都来自互联网，版权归原作者所有。如读者和版权方有任何异议请及时告之，我们将妥善解决。
- 2.本站提供的中文数据手册是英文数据手册的中文翻译，其目的是协助用户阅读，该译文无法自动跟随原稿更新，同时也可能存在翻译上的不当。建议读者以英文原稿为参考以便获得更精准的信息。
- 3.本站提供的产品资料，来自厂商的技术支持或者使用者的心得体会等，其内容可能存在描述上的差异，建议读者做出适当判断。
- 4.如需与我们联系，请发邮件到marketing@iczoom.com，主题请标有“数据手册”字样。

## Read Statement

1. The datasheets and other product information on the site are all from network reference or other public materials, and the copyright belongs to the original author and original published source. If readers and copyright owners have any objections, please contact us and we will deal with it in a timely manner.
2. The Chinese datasheets provided on the website is a Chinese translation of the English datasheets. Its purpose is for reader's learning exchange only and do not involve commercial purposes. The translation cannot be automatically updated with the original manuscript, and there may also be improper translations. Readers are advised to use the English manuscript as a reference for more accurate information.
3. All product information provided on the website refer to solutions from manufacturers' technical support or users the contents may have differences in description, and readers are advised to take the original article as the standard.
4. If you have any questions, please contact us at marketing@iczoom.com and mark the subject with "Datasheets" .

# Radial Lead Fuses

TR3 > Fast-Acting Fuse > 303 Series

## 303 Series, TR3, Fast-Acting Fuse



### Agency Approvals

Agency	Agency File Number	Ampere Range
	E67006	0.050A - 5A
	051378	0.050A - 5A

### Electrical Characteristics

% of Ampere Rating	Opening Time
200	60 Seconds, Maximum

### Description

The 303 Series are TR3, fast-acting type, 125V rated fuses designed in accordance to UL 248-14.

### Features

- Reduced PCB space requirements
- Direct solderable or plug-in versions
- Internationally approved
- Low internal resistance
- Shock safe casing
- Vibration resistant
- RoHS compliant, Lead-Free and Halogen-Free
- Available from 0.050A to 5A

### Applications

- Battery chargers
- Consumer electronics
- Power supplies
- Industrial controllers

### Additional Information



Datasheet



Resources



Samples

### Electrical Characteristics

Amp Code	Rated Current	Voltage Rating	Breaking Capacity	Nominal Cold Resistance (Ohms)	Voltage Drop $1.0 \times I_N$ max. (mV)	Power Dissipation $1.0 \times I_N$ max. (mW)	Melting Integral $10 \times I_N$ max. (A <sup>2</sup> s)	Approvals	
0050	50mA	125V	50A @ 125VAC 50A @ 63VDC	2.9203	800	40	0.00007	X	X
0063	63mA	125V		2.7400	780	50	0.00013	X	X
0080	80mA	125V		2.2300	730	60	0.0002	X	X
0100	100mA	125V		4.3800	700	70	0.0004	X	X
0125	125mA	125V		3.4605	650	85	0.0022	X	X
0160	160mA	125V		2.1687	600	100	0.0029	X	X
0200	200mA	125V		1.3500	550	110	0.0042	X	X
0250	250mA	125V		1.1500	500	125	0.0082	X	X
0315	315mA	125V		0.9645	450	145	0.015	X	X
0400	400mA	125V		0.8050	400	160	0.025	X	X
0500	500mA	125V		0.5320	380	190	0.042	X	X
0630	630mA	125V		0.1448	160	100	0.015	X	X
0800	800mA	125V		0.1023	155	125	0.025	X	X
1100	1.00A	125V		0.0830	150	155	0.039	X	X
1125	1.25A	125V		0.0644	145	185	0.059	X	X
1160	1.60A	125V		0.0520	140	225	0.11	X	X
1200	2.00A	125V		0.0400	130	260	0.17	X	X
1250	2.50A	125V		0.0307	125	315	0.23	X	X
1315	3.15A	125V		0.0262	120	380	0.45	X	X
1400	4.00A	125V		0.0178	110	440	1.0	X	X
1500	5.00A	125V	0.0131	105	525	1.5	X	X	

Note: 1.00 means the number one with two decimal places. 1,000 means the number one thousand.

**Temperature Re-rating Curve**

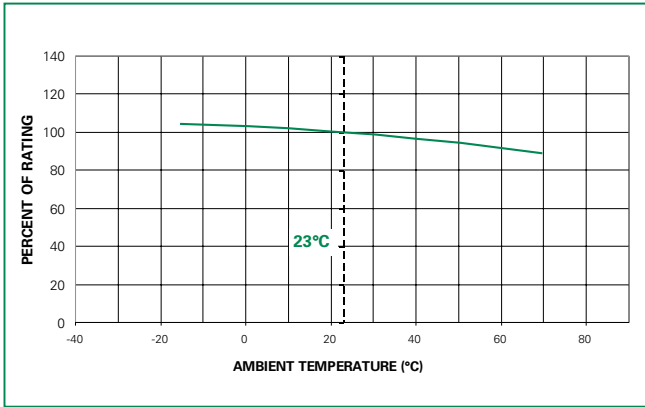

Note  
1. Rerating depicted in this curve is in addition to the standard derating of 25% for continuous operation.

**Average Time Current Curves**

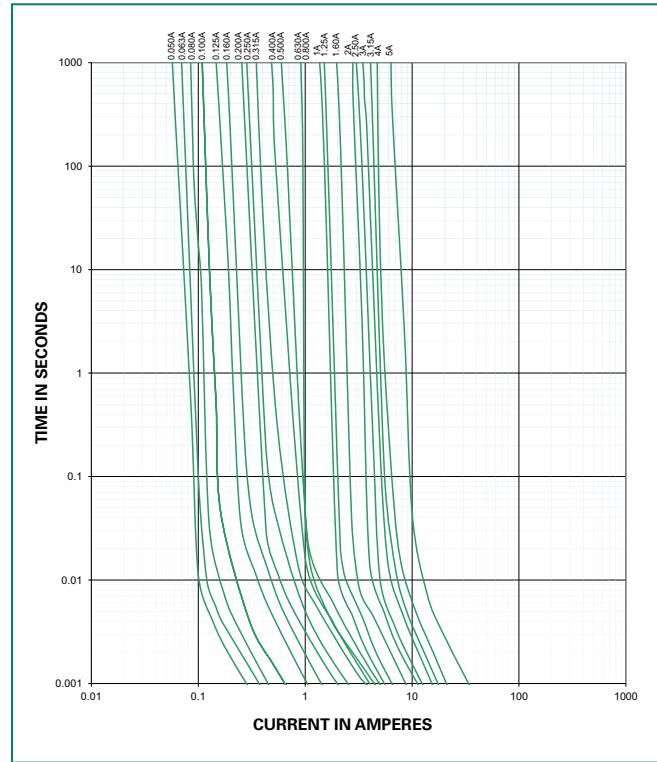

**Soldering Parameters - Wave Soldering**

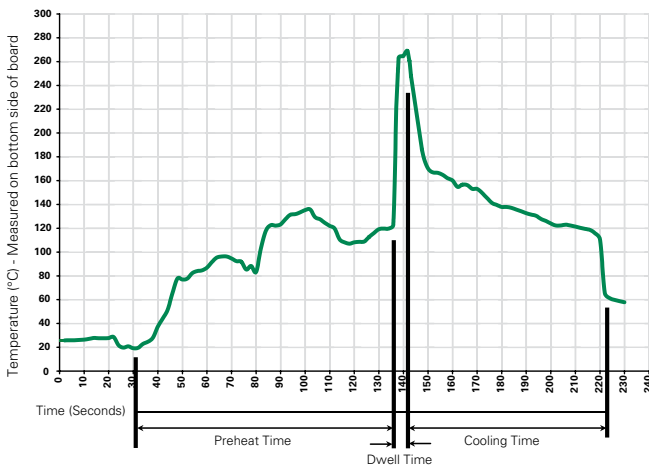

**Recommended Process Parameters:**

Wave Parameter	Lead-Free Recommendation
<b>Preheat:</b> (Depends on Flux Activation Temperature)	(Typical Industry Recommendation)
Temperature Minimum:	100°C
Temperature Maximum:	150°C
Preheat Time:	60-180 seconds
<b>Solder Pot Temperature:</b>	260°C Maximum
<b>Solder Dwell Time:</b>	2-5 seconds

**Recommended Hand-Solder Parameters:**

Solder Iron Temperature: 350°C +/- 5°C  
Heating Time: 5 seconds max.

**Note: These devices are not recommended for IR or Convection Reflow process.**

### Product Characteristics

<b>Materials</b>	Base/Cap: Black Thermoplastic Base Polyamide PA 6.6, UL 94V-0 Brass, Nickel-plated Cap Round Pins: Copper alloy, Tin-plated
<b>Lead Pull Strength</b>	10 N (IEC 60068-2-21)
<b>Solderability</b>	260°C, ≤ 3s. (Wave) 350°C, ≤ 1s. (Soldering Iron)
<b>Soldering Heat Resistance</b>	260°C, 10s. (IEC 60068-2-20) 350°C, 3s. (Soldering Iron)

<b>Operating Temperature</b>	-25°C to +70°C (consider de-rating)
<b>Climatic Category</b>	-25°C/+70°C/21 days (IEC 60068-1-3)
<b>Stock Conditions</b>	+10°C to +60°C RH, ≤75% yearly average, without dew
<b>Vibration Resistance</b>	24 cycles at 15 min. each (IEC 60068-6) 10 - 60 Hz at 0.75 mm amplitude 60 - 2000 Hz at 10 g acceleration

### Dimensions

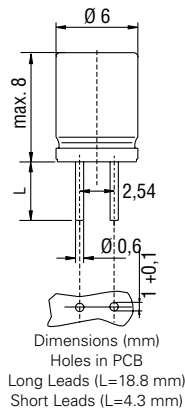

### Part Numbering System

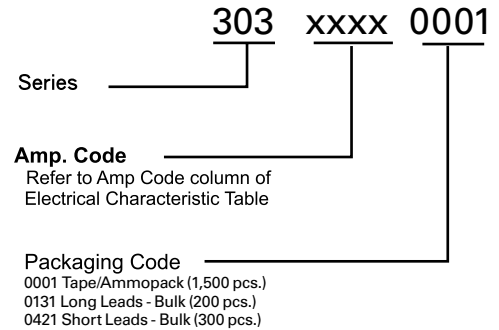

### Packaging

Packaging Option	Packaging Specification	Quantity	Quantity & Packaging Code	Reel Size
<b>303 Series</b>				
Tape & Ammopack	N/A	1,500	0001	N/A
Long Leads	N/A	200	0131	N/A
Short Leads	N/A	300	0421	N/A